

**VeriCon**

**LSA**

draaijer+partners  
powered by the DraaijerGroup

**atriensis**  
projecten

**voort**

**DURAVERMEER**  
Waarmerken van ambities

**blitta**  
gevelsystemen



**zonneveld**  
ingenieurs



**BIM**  
**CONNECTED**



**VolkerWessels**

**abcrova**  
ADVISEURS | PROJECTMANAGERS | PROCESMANAGERS

**Royal HaskoningDHV**  
Enhancing Society Together



Bouwkunde Bedrijvendagen - Company Guide 2022

Company Guide 2022



**Turner & Townsend**



**Stichting Bouwkunde**  
**Bedrijvendagen**

Technische Universiteit Eindhoven  
Vertigo 1.52  
Den Dolech 2  
5612 AZ Eindhoven

Postbus 513  
5600 MB Eindhoven

e: [info@bouwkundebedrijvendagen.nl](mailto:info@bouwkundebedrijvendagen.nl)  
w: [www.bouwkundebedrijvendagen.nl](http://www.bouwkundebedrijvendagen.nl)



**BOUWKUNDE**  
**BEDRIJVEN**  
**DAGEN**

### Colophon

This Company Guide is a publication of Stichting Bouwkunde Bedrijvendagen on occasion of the 21st edition of Bouwkunde Bedrijvendagen in 2022.

### Contact Address

Stichting Bouwkunde Bedrijvendagen  
Eindhoven University of Technology

Postbus 513  
5600 MB Eindhoven

✉ [info@bouwkundebedrijvendagen.nl](mailto:info@bouwkundebedrijvendagen.nl)  
🌐 [www.bouwkundebedrijvendagen.nl](http://www.bouwkundebedrijvendagen.nl)

### Editorial Office

Bouwkunde Bedrijvendagen,  
Promotion Committee 2021-2022

# Table of Contents

<b>Preface</b>	4
<i>Turner &amp; Townsend</i>	
<b>Committee of Recommendation</b>	6
<b>Preface</b>	8
<b>20th Board</b>	9
<b>Activities and Program</b>	10
Kick-Off	12
Lecture OMA	13
Lecture Powerhouse	14
1-on-1 Interviews	15
Career Market	16
Debate	17
Cases	18
Company Dinner	20
<b>Study and Sub-associations</b>	23
<b>Company Classification</b>	24
<b>Companies</b>	28
<b>Expression of Gratitude</b>	122

# Preface

*Turner & Townsend*

Dear students,

We share your passion for construction and the built environment, and we're excited to be a part of the TU Eindhoven Bouwkunde Bedrijvendagen. What a fantastic opportunity for students and companies to get to know each other and how amazing that we can finally meet face-to-face again.

While the world has started to live with the impacts of COVID-19, the global pandemic has accelerated the drivers for change across all aspects of our lives and communities. We believe that the construction industry is facing a period of significant transformation and is pivotal to solving many of society's biggest issues, not least the transition to net zero. There is almost universal recognition of the need for change, and the role that the construction industry must play.

As leaders in the construction and built environment industry, we understand the vital need to step forward with solutions to the growing global climate crisis and help limit global temperature rises to 1.5 degrees Celsius by 2050. By driving solutions for sustainable development, we are innovating in our industry and together with our clients we are part of a positive shift to a more sustainable society now and in the future. Our aim is to help clients use resources more efficiently and create solutions that last.

All over the world people are using buildings, infrastructure and assets we helped to deliver. It could be the hospital they work in, the railway they travel on every day, the fuel that powers their car or the data centre they depend on at work.

That makes us proud, as we strive to make a difference: through creating a world where opportunities are open to all, people can live healthy and prosperous lives and our industry positively impacts the natural environment around it.

It's exciting to be a part of this industry. We've been in the business for over 75 years and we will celebrate 25 years in the Netherlands this year. We are a company of tradition and values. We equally embrace change, innovation and technology. For this reason, we enjoy meeting bright students from all over the world to exchange ideas about the future and listen to your view on the world as future leaders of the construction industry.

We wish you all very inspiring and motivating weeks.

Kind regards,  
Turner & Townsend





# Committee of Recommendation

2021-2022

The initiative of the Bouwkunde Bedrijvendagen is supported by the following persons:



*Prof. Dr. Ir.*  
**Theo Salet**  
Dean Faculty of the  
Built Environment  
TU Eindhoven

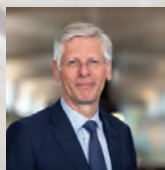

*Prof. Dr. Ir.*  
**Frank Baaijens**  
Rector Magnificus  
TU Eindhoven



**Merle Rodenburg**  
Managing Director  
Faculty of the Built  
Environment  
TU Eindhoven



*Ir.*  
**Jan van der Meulen**  
Director of Education  
Faculty of the Built  
Environment  
TU Eindhoven



**Luke Bartolo**  
Managing Director  
Netherlands  
Turner & Townsend



*Drs. Ing.*  
**Miguel Delcour**  
Director  
KIVI



*Drs.*  
**Maxime Verhagen**  
Chairman  
Bouwend Nederland



**Karin Oomen**  
Advisor Education &  
Job Market  
Bouwend Nederland



*Prof.*  
**Tim van der Hagen**  
Rector Magnificus  
TU Delft



*Prof. Ir.*  
**Dick van Gameren**  
Dean Faculty of the  
Built Environment  
TU Delft



*Prof. Dr.*  
**Tom Veldkamp**  
Rector Magnificus  
University of Twente



*Prof. Dr. Ir.*  
**Bert Blocken**  
Professor BPS  
TU Eindhoven

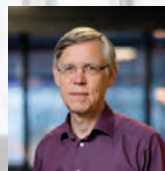

*Prof. Dr. Ir.*  
**Bauke de Vries**  
Professor USRE  
TU Eindhoven



*Prof. Ir.*  
**Juliette Bekkering**  
Professor AUDE  
TU Eindhoven



*Prof. Ir.*  
**Bert Snijder**  
Professor SD  
TU Eindhoven



# Preface

## Board 2021-2022

Dear students of the Built Environment,

Welcome to this year's edition of the Bouwkunde Bedrijvendagen. As we are the 20th board, nineteen other boards have, in two decades, gone before us. It is a great honor to host the BBD events once again. The main goal of our events is to bring students, from all disciplines and academic levels, in contact with Built Environment companies in order to help create and improve their professional network. While COVID-19 has had a hold over the last year and still has, we are grateful for the opportunity to organize these events for networking under these special circumstances.

The Built Environment and its studies consist of multiple disciplines. Here in Eindhoven, future engineers are creating a foundation in the disciplines of architecture, building physics, structural design, urbanism and real estate. This basis then allows for a specialization into the preferred discipline(s). As this choice is influential for the future, it is important to know all aspects and options. We, as the Bouwkunde Bedrijvendagen, together with our main sponsor Turner & Townsend and this year's participating companies, give insight in the many possible disciplines and working fields that the Built Environment has to offer for either one's future. Our slogan 'Enlighten Your Tomorrow' represents combining the knowledge you have with the experience you gain and putting that towards a clearer and brighter future for yourself. At the events students get the opportunities to boost their skills, find goals and ambitions and work on their future. All companies from different disciplines attending will give insight into what your future could look like to Enlighten Your Tomorrow!

To make all of this happen we as a board have been working this year. Besides the events we have worked on updating the website to make it bilingual, so it is accessible for everyone and improving the portal for easier subscription to our events. Furthermore, some of our events have been renewed, such as the newly named Kick-Off day and Debate.

The Bouwkunde Bedrijvendagen will this year start with the Kick-Off day, where masterclasses are given to prepare all students for the networking events. Then a selection of orienting events starts, the lectures hosted will provide insight into two companies and their projects. The Debate this year provides the opportunity where four parties involved in the Built Environment talk about an important topic that affects all of us. The highlight of the Bouwkunde Bedrijvendagen, the Career Market, is the perfect place to walk around and browse through all companies present and get in contact with them. Furthermore we host a couple of events in which you can pursue more formal and in-depth contact with companies, such as the 1-on-1 Interviews where you can even apply for an internship or job. In the Cases you work out an actual project the participating company has, so you can see first-hand how companies approach such a case. Finally the Company Dinner allows for a conversation with a select group while enjoying a three-course dinner.

With this selection of events we are certain there is something for everyone and we hope to see you at our events to Enlighten Your Tomorrow!

- The 20th board of the Bouwkunde Bedrijvendagen

## Board 2021-2022



**Stig Wesselink**  
*Chairman*  
*Member of Organisation Day*



**Bram Wierbos**  
*Secretary*  
*Member of Business Contact*



**Cas Berkelmans**  
*Treasurer*  
*Member of Promotion*



**Frederiek Prins**  
*Head of Organisation Day*



**Sofia Ghigliani**  
*Head of Business Contact*



**Nayla Groenendijk**  
*Head of Promotion*



**Thijs Schutten**  
*Member of Organisation Day*



**Ka Hao Cheung**  
*Member of Business Contact*

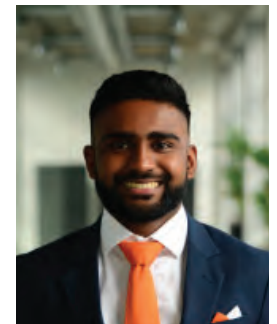

**Jathavan  
Kodiswaranathan**  
*Member of Promotion*

## Activities



Kick-Off



Lecture



Cases



Debate: Vision on the Housing Crisis



1-on-1 Interviews



Career Market



Company Dinner

## Program



10:30 - 15:30  
**Kick-Off &  
Masterclasses**



12:45 - 13:30  
**Lecture**  
OMA



12:45 - 13:30  
**Lecture**  
Powerhouse



8:45 - 12:15  
**1-on-1 Interviews**  
12:30 - 16:00  
**Career Market**



12:45 - 13:30  
**Debate: Vision on  
the Housing Crisis**



13:30 - 17:00  
**Cases**  
18:00 - 20:00  
**Company Dinner**





## Kick-Off

The Bouwkunde Bedrijvendagen events will start with the Kick-Off on the **23rd of February**.

This event gives students the opportunity to work on presenting themselves and making a good first impression at all the events of the Bouwkunde Bedrijvendagen.

During this day, masterclasses will be given by TU/e Career Academy and Voort and LinkedIn pictures will be taken.

Career Academy will teach you more about labor contracts and how to negotiate during the job application process in the Negotiation masterclass. During Networking you will learn how to optimize your networking conversations, especially useful for the Career Market.

In one of the masterclasses of Voort you will learn the do's and don'ts when making your motivation letter and get your CV checked. In the other masterclasses you can learn how to get the most out of your LinkedIn account, what to do during a job interview and what type of functions and companies suit you best during the Career Test.

By attending the Kick-Off, you will be better prepared for the events of the Bouwkunde Bedrijvendagen and your future career!

The subscription for the Kick-Off masterclasses closes on the **20th of February**.



## OMA Lecture

During the first lecture of the Bouwkunde Bedrijvendagen on the **24th of February**, Bozar Ben Zeev is going to enlighten us about OMA's recent VDMA Eindhoven project and share his experience of studying Rem Koolhaas in university to being an architect at OMA.

VDMA Eindhoven is OMA's most recent large-scale project in the Netherlands. The masterplan aims to transform a derelict site in the city center of Eindhoven into a mixed-use area that will address local housing needs, accommodate leading technology companies and introduce exciting public spaces. Once completed, the revitalized VDMA will be one of OMA's most sustainable projects to date, featuring timber and modular construction methods, energy-generating facades and a Micro Forest – a dense green space that nurtures local flora and fauna. The VDMA project is overseen by OMA's Managing Partner – Architect, David Gianotten.

Bozar Ben Zeev is Project Leader and Architect at OMA, and has previously worked in Amsterdam, London and Beijing. He is a former teacher at the Architectural Association and graduated from both TU Delft and the Architectural Association.



## Powerhouse Lecture

The second lecture of the Bouwkunde Bedrijvendagen will be given by Powerhouse and takes place on the **8th of March**.

In 2015, a competition was held to find a suitable redevelopment plan for De Bunker, the former student center of the TU/e. Powerhouse Company came up with a vision for a vibrant multi-use development by renovating the Bunker's existing structure and adding a striking new residential tower. The key to the project was transforming the post-war monument with a unified, layered design that celebrates the spirit of the building, originally designed by leading postwar Dutch architect Hugh Maaskant.

In this lecture, Partner Architect Stijn Kemper will talk about Maaskant's icon and how Powerhouse Company analyzed his design language to revive the building's original glamor and propel it into the 21st century while conserving its Brutalist architectural elements.

Stijn Kemper (1979, Netherlands) studied architecture here at the TU/e, graduated in 2007 and joined Powerhouse in 2008. Next to the Bunker Tower, he has worked as a project architect on multiple schemes, such as Villa L, Loop of Wisdom in Chengdu, China, the Hangzhou Airport Terminal 4 competition, and inSports Beijing.



## 1-on-1 Interviews

The 1-on-1 interviews will take place on the **9th of March**. In this formal 15-minute face-to-face conversation, student and company can get into depth with certain topics, discuss the Built Environment and negotiate internship or job opportunities. The following companies will be present at the 1-on-1 interviews

- abcnova
- Arcadis
- Atrienis projecten
- BESIX Nederland
- BIM-Connected
- Blitta Gevelsystemen
- Bulsink Group
- CBRE
- Ector Hoogstad
- EGM architects
- Goudstikker - de Vries
- Koninklijke BAM Groep
- Laanbroek Schoeman adviseurs & draaijer+partners
- Powerhouse Company
- RoosRos Architecten
- Royal HaskoningDHV
- Stadlander
- Sweco Nederland
- Turner & Townsend
- TwynstraGudde
- VeriCon Ingenieurs
- VolkerWessels Bouw & Vastgoedontwikkeling
- Witteveen + Bos
- Zonneveld ingenieurs

Your CV is required as companies select students based on CV uploads. The subscription for this closes on the **20th of February**.





## Career Market

The most renowned event of the Bouwkunde Bedrijvendagen, the Career Market, will take place at the **9th of March**. During this market, a diverse selection of companies that give representation of the possibilities in the Built Environment sector will be present at Plaza in Vertigo **from 13:00h until 16:30h**. After Theo Salet, the dean of the faculty, has opened the market by a talk you can walk around and talk to all different types of interesting companies. Not only companies will be present, also all study associations on the market, to inform you of the companies that fit their discipline. If you are not sure where to start, you can also join a tour by one of the study associations.

At the Career Market, getting in contact with your future employer has never been so easy!



## Debate: Visions on the Housing Crisis

During the lunch break on Friday the **11th of March** the debate will take place. This year, stakeholders from different disciplines in the field of the Built Environment will take part in a conversation about the current shortage of houses through the high demand and low production. What are the reasons we are in this situation? How did it come so far? And how are we getting out of here? The solution is not that simple. Different aspects play large roles in this process.

In the conversation, we will look at the crisis from the perspective of the architects, the urbanists, the building physicists and even the municipality of Eindhoven.

The directions will be represented by:

- Sweco (B)
- SVP architectuur en stedenbouw (A)
- Brink (U)
- Municipality of Eindhoven (U)

All of them play a different role in this and only together, they are able to find a solution. They will have a conversation guided by radio presenter Jan Willem Wesselink. Join the debate and find out what everyone has to say!





## Cases

Put your knowledge to the test by applying them in practice! This year, the cases will take place on the **14th of March** from 13:30h until 16:30h. In total three different cases will be given in three different directions of the Built Environment.

During the cases you will be able to get a glimpse of real-world problems tackled by companies and work on one yourself with guidance from a specialized company in a certain field to get a feeling of how working there would be. The three different cases will be given by **Snijders Ingenieursgroep (B)**, **BiermanHenket (A)** and **Turner & Townsend (U)**.

### Snijders Ingenieursgroep:

Designing a high-rise tower is already quite a challenge but designing this tower in prefab is next level! Such a design involves all kinds of challenges: How do you ensure the stability of the building? How do you get the prefab elements from the factory to the construction site and how do you make sure that all facilities are included? You don't just look at the final situation of the building, but also at the situation during the assembly. How can the elements be temporarily braced? What is the construction sequence? These are all questions that make this case an interesting and challenging puzzle, just like in the real-world. In this case study, you are involved in the whole process, from the preliminary to the final phase.



The challenge is to design a high-rise tower in the heart of Amsterdam and use rough manual calculations to find out what kind of forces we are talking about. While brainstorming, some key details in couplers and anchors used in steel and concrete construction will be shown and used to steer the conversation.

### BiermanHenket:

The case is to transform the former monumental Citroën garage in Amsterdam to a multifunctional and high standard building. One part of the building will be renovated, and the other half of the building will be demolished and rebuilt. Together we will talk about the program and work on the sketch design for the new building. This will contain sketches and a small model. How will the mass look like? How will it react to the existing part with its own monumental architecture? And what is the influence of the surrounding to the design? These are questions that will become clear during the design process and which we will discuss.

### Turner & Townsend:

The case given by Turner & Townsend will be about The Shell Headquarters. This is a project that comprises four buildings, totaling approximately 110,000 sqm, mixing heritage buildings with a modern, sustainable headquarters. In this case, you get the chance to learn how to control this construction project from a financial point of view.

The subscription for the Cases closes on the **11th of March**.





## Company Dinner

The Company Dinner will be the closing event of this year's edition and will take place on the **14th of March** from 18:00h until 20:00h, after which all participating students will be invited for a drink.

During this event, an informal atmosphere is created in which students get the chance to talk to companies in a casual manner. Per table, a maximum of six students get the chance to talk with the representative(s) of a company. The Company Dinner will consist out of three rounds, each including a course. After each round the students will switch tables and thus companies, so you get a chance to talk to different players of the Built Environment.

The participating companies are:

- abcnova
- AT Osborne
- Atriensis
- Besix
- B-invented
- Bultsink
- CBRE
- Dura Vermeer
- Ector Hoogstad
- OLCO
- Tielemans
- Turner & Townsend
- TwynstraGudde
- VeriCon

The subscription for the Company Dinner closes on the **11th of March**.









## Study and Sub-associations



 [cheops.cc](http://cheops.cc)  
 [info@cheops.cc](mailto:info@cheops.cc)



Built Environment Study Association



 [anarchi.cc](http://anarchi.cc)  
 [info@anarchi.cc](mailto:info@anarchi.cc)

AUDE (A)



 [viaurbanism.nl](http://viaurbanism.nl)  
 [via@bwk.tue.nl](mailto:via@bwk.tue.nl)



AUDE (U)



 [mollier.nl](http://mollier.nl)  
 [info@mollier.nl](mailto:info@mollier.nl)

BPS



 [ofcoursecme.nl](http://ofcoursecme.nl)  
 [ofcourse@bwk.tue.nl](mailto:ofcourse@bwk.tue.nl)



CME



 [www.koerstue.nl](http://www.koerstue.nl)  
 [info@koerstue.nl](mailto:info@koerstue.nl)

SED



 [service-studievereniging.nl](http://service-studievereniging.nl)  
 [info@service-studievereniging.nl](mailto:info@service-studievereniging.nl)

USRE

# Company Classification

The faculty of the Built Environment at the TU/e offers 5 mastertracks and 2 certificate programmes, each tailored towards a certain field within the built environment. As a lot of companies in the built environment are multifaceted and active in more than one field, it might be hard to distinguish their exact direction. Hence, based on the offered mastertracks at the TU/e, a classification is made for all participating companies at the Bouwkunde Bedrijvendagen to make it easier for you to choose your preferred direction and companies to get in touch with during the events.

AUDE  
(A)

Architectural & Urban Design Engineering: This track stands at the cradle of inventive (design) solutions for concrete spatial issues, emphasizing the possibilities of the program, and ensuring a high quality of context. The **architecture** specialisation within this track mainly focuses on designing buildings for the future.

AUDE  
(U)

Architectural & Urban Design Engineering: This track stands at the cradle of inventive (design) solutions for concrete spatial issues, emphasizing the possibilities of the program, and ensuring a high quality of context. The **urbanism** specialisation within this track mainly focuses on spatial design and city layers.

BPS

Building Physics & Services: Providing sustainable and comfortable indoor and outdoor environment with attention to physical aspects and processes such as heat and moisture transfer in building constructions, indoor air quality, lighting, acoustics, heating, ventilation, air-conditioning and materials.

CME

Construction Management & Engineering: This track focusses on process and project management, collaborative design and legal structures, with its focuspoint on information systems in smart cities and smart buildings.

SED

Structural Engineering & Design: Innovative constructive design, material research and applied mechanics, with core focus on knowledge and application of different structural materials as well as on several methods to solve mechanical problems.

USRE

Urban Systems & Real Estate focusses on the functioning and research in the field of real estate management, urban planning, (re)development and management of cities and developing systems to support designers and decision makers.

BT/CT

**Building Design & Technology (BT)\*:** emphasizes on the relation between the design of the building and its technical elaboration.

**Construction Technology (CT)\*:** emphasizes on independent designing and developing a production process for the construction of a building by using materials, equipment and labor in the most optimal way.

\* These are no longer separate master tracks, but are achievable as certificate programmes in addition to any of the master tracks and offer the possibility to broaden your education.

## Orientation

On the next pages, a list of companies that are participating in the events of Bouwkunde Bedrijvendagen is provided. All companies are classified based on this colour-coded classification to the master tracks they the best match with. Note that some companies are involved in multiple work fields and therefore have multiple matches.

If you're interested in a company and would like to read more about the work in its active branch, are orienting for career options or just want to know in which events they participate, look up the corresponding page number of their dedicated company pages in the list of participating companies and read more about it.

On the bottom right of the company pages, an indication is given using orange activity symbols for every company, stating in which events they participate during the Bouwkunde Bedrijvendagen.

As part of the MyFuture collective, MFA can be earned by participating in all of the events organised as part of the Bouwkunde Bedrijvendagen



## Companies

	Page Nr.	AUDE (A)	AUDE (U)	BPS	CME	SED	USRE	BT	CT
1. abcnova	28								
2. Adviesbureau Tielemans	30								
3. Arcadis	32								
4. ASK Romein	34								
5. AT Osborne	36								
6. Atrienis projecten	38								
7. Aveco de Bondt	40								
8. B-invented B.V.	42								
9. bbn adviseurs	44								
10. BESIX Nederland	46								
11. BiermanHenket	48								
12. BIM-Connected	50								
13. Blitta Gevelsystemen	52								
14. BREED Integrated Design	54								
15. Brink Management / Advies	56								
16. Bulsink Group	58								
17. CBRE	60								
18. Count & Cooper	62								
19. Dura Vermeer	64								
20. Ector Hoogstad Architecten	66								
21. EGM architecten	68								
22. Goudstikker - de Vries	70								
23. Heijmans	72								
24. Koninklijke BAM Groep	74								
25. Laanbroek Schoeman adviseurs & draaijer + partners	76								
26. LBP   SIGHT	78								

## Companies

	Page Nr.	AUDE (A)	AUDE (U)	BPS	CME	SED	USRE	BT	CT
27. MVSA Architects	80								
28. Nieman Raadgevende Ingenieurs	82								
29. OLCO Maatschappelijk Vastgoed	84								
30. Peutz	86								
31. Powerhouse Company International	88								
32. RoosRos Architecten	90								
33. Royal HaskoningDHV Nederland	92								
34. Scheldebouw	94								
35. Snijders Ingenieursgroep	96								
36. Stadlander	98								
37. SVP architectuur en stedenbouw	100								
38. Sweco Nederland	102								
39. Tentech	104								
40. Turner & Townsend	106								
41. TwynstraGudde	108								
42. VeriCon Ingenieurs Veldhoven	110								
43. VolkerWessels Bouw & Vastgoedontwikkeling	112								
44. Voort	114								
45. Witteveen+Bos	116								
46. Zonneveld ingenieurs	118								

## Branch

Consultancy and Project/process management

## HQ Location

Utrecht

## Employees

95



## Classification

- AUDE (A)    ● SED
- AUDE (U)    ● USRE
- BPS    ● BT
- CME    ● CT

## Contact person

Mirjam Knegjens, HRM

## Visiting address

2e Daalsedijk 6a  
3551 EJ  
Utrecht

+31 88 0215315

hrm@abcnova.nl

abcnova.nl

linkedin.com/company/abc-nova



abcnova

ADVISEURS | PROJECTMANAGERS | PROCESMANAGERS

Everyday our consultants and project managers create future-oriented solutions for living, working and learning environments together with our clients. We realise the ambitions of our clients and enable them to stay on top of the construction process. Our people always aim for the best possible results, preferably taking it even one step further. In this way, we help make the real estate industry a better place, every day.

We are a successful company that is contributing to high-profile buildings and areas. Feyenoord City, microcity "Het Platform", redevelopment of V&D Eindhoven and the city hall in Utrecht are some examples of projects we are proud of!

At abcnova, we take pride in our expertise and skills. Our dynamic organisation is founded on experienced consultants and project and process managers. We offer our employees the kind of working and learning environment that nurtures their talents and curiosity. For instance, we organise many knowledge sessions with both in-house and external experts.



## Young Talent Program

abcnova is always on the look-out for people who are passionate about their profession. People who get up in the morning determined to make a difference and make our built environment more beautiful and more clever. If you join our team as a young, ambitious and enthusiastic talent you will participate in the young talent program. This is a development program in which you work on broad professional knowledge, personal skills and effectiveness. You will also automatically become a member of the 'young abcnova' (JAN) community run by and for junior project managers. JAN focusses on internal and external networking and knowledge sharing with lots of room for fun activities.



## Kick-start your career at abcnova

Do you want to experience for yourself what it is like to work in the dynamic world of project management and kick-start your career? We always welcome graduates, trainees and working students. Contact us for the possibilities!

At abcnova, we encourage people to excel at the individual level, but we also encourage them to become great teamplayers.

Interested in working at abcnova? Scan the QR-code to view available vacancies





# Adviesbureau Tielemans

Branch  
Consultancy

HQ Location  
Eindhoven

Employees  
35

## Classification

- AUDE (A)
- AUDE (U)
- BPS
- CME
- SED
- USRE
- BT
- CT

Contact person  
Marcel Meulendijks

Visiting address  
Insulindelaan 113  
5642 CV  
Eindhoven

+31 40 2814455

mmeulendijks@tielemans.nl

tielemans.nl

linkedin.com/company/  
adviesbureau-tielemans-bv



Since its foundation in 1958 Adviesbureau Tielemans has become one of the largest and most leading structural consultants in this region. Based in Eindhoven, our engineers work with reputable national and international architects on innovating and eye-catching projects both in the Netherlands and abroad. Come see us at our stand and learn what our office has to offer you as a talented engineer!

Working at Adviesbureau Tielemans in a design team you aim for the highest achievable combination of shape, structural efficiency and function. This also means following the technological developments in our field so that they can directly contribute to the desired result in practice. Depending on your own skills, you will have the opportunity and support to grow into a project manager function in a short period of time. Within every project we are facing the challenge to elaborate any architectural concept to a suitable structural design.

This resulted in the recently awarded prices:  
"Domus Dela" BNA Building of the year public award 2020 and Dirk Roosenburg public award 2021;  
Haasje Over (top photo) won residential building of the year by Architectenweb; Onyx won Holland Hoogbouw Award 2019.



Adviesbureau Tielemans is situated nearby Eindhoven University of Technology. Hence, knowledge and structural design are close together. This means there is a high probability that, as a student of the University, you have seen projects in Eindhoven of which Adviesbureau Tielemans has designed the main bearing structure. For example, some highrise on Strijp-S: Blok 59, NEXT, The Lux Tower, Trudotoren and Haasje Over, but also de Bakermat, Onyx, The Student Hotel and renovation of the Stadhuisoren, Philips Bedrijfschool and TD-gebouw.

Some other recent projects around the Netherlands include Nehmo Trespa (bottom photo), Aan de Kei, Bellavista, fire station Waalwijk, police station Bergen op Zoom and the Willemspoort.

If you are interested, come and meet our engineers at the Adviesbureau Tielemans stand!

Interested in working at Adviesbureau Tielemans? Scan the QR-code to view available vacancies



# Arcadis

## Branch

Engineering and Consultancy

## HQ Location

Amsterdam

## Employees

30



## Classification

- |            |        |
|------------|--------|
| ● AUDE (A) | ● SED  |
| ● AUDE (U) | ● USRE |
| ● BPS      | ● BT   |
| ● CME      | ● CT   |

## Contact person

Wies van Hoek, HR

## Visiting address

Piet Mondriaanlaan 26  
3812 GV  
Amersfoort

+31 6 11672571

wies.vanhoek@arcadis.com

arcadis.com

linkedin.com/company/arcadis



With sustainability at the heart of everything we do, our focus is on maximizing our impact aimed at improving quality of life. The solutions we develop address important societal challenges around resilience, places, and mobility. Leveraging data and technology, we have the capabilities and services to meet client demands driven by global trends such as urbanization, climate change, digitalization, evolving stakeholder expectations and potential unforeseeable events.

We embed sustainability across everything we do and apply our wealth of expertise and skills to deliver client solutions that are competitive, resilient, effective, and within planetary boundaries.

As a business, we want to maximize our impact by harnessing the power of technology and data to develop solutions to today's global challenges. We are focused on improving the way resources are utilized, protecting our environment, creating transporting solutions, and planning for the places where we can enjoy our work and home lives.

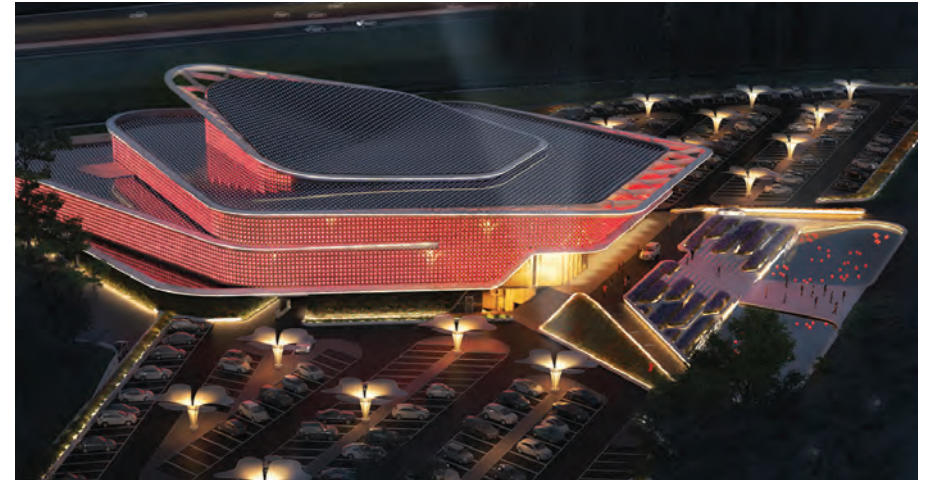

Interested in working at Arcadis? Scan the QR-code to view available vacancies.





## ASK Romein

**Branch**  
Construction

**HQ Location**  
Roosendaal

**Employees**  
600

### Classification

- |            |        |
|------------|--------|
| ● AUDE (A) | ● SED  |
| ● AUDE (U) | ● USRE |
| ● BPS      | ● BT   |
| ● CME      | ● CT   |

### Contact person

Jasper Kunstt, Recruitment/HR

### Visiting address

Belder 101  
4704 RK  
Roosendaal

☎ +31 6 15271868

✉ j.kunstt@ask-romein.com

🌐 ask-romein.com

🌐 linkedin/com/company/  
ask-romein



ASK Romein is a construction company group with offices in Belgium and the Netherlands and customers all over the world. Our continuous investment in complementary construction activities makes us a specialist partner with all the technical expertise to design and deliver (turnkey) construction projects and all types of complex (steel) projects down to the last detail. Type of projects: Datacenters, Distributioncenters, Sportfacilities, Hotels, Musea and more.

ASK Romein is a multi-disciplinary firm with all aspects of build & design present. From engineering to production of steel. From logistics to project management. Last but not least: we are an expert in assembling steel constructions and additional cladding.



## JOIN OUR TEAM? HIGH FIVE!

SOLLICITEER NU EN  
GROEI SAMEN MET ONS MEE!  
[WWW.ASK-ROMEIN.NL/VACATURES](http://WWW.ASK-ROMEIN.NL/VACATURES)



ASK ROMEIN | Belder 101 | NL-4704 RK Roosendaal | ☎ +31 (0)165 750 300 | ✉ info@ask-romein.com

Interested in working at  
ASK Romein? Scan the  
QR-code to view available  
vacancies.



## AT Osborne

### Branch

Real estate, Management and Consultancy

### HQ Location

Baarn

### Employees

150



### Classification

- |            |        |
|------------|--------|
| ● AUDE (A) | ● SED  |
| ● AUDE (U) | ● USRE |
| ● BPS      | ● BT   |
| ● CME      | ● CT   |

### Contact person

Marloes de Haas,  
Housing RE Healthcare

### Visiting address

J.F. Kennedylaan 100  
3741 EH Baarn

+31 35 5434343

info@atosborne.nl

atosborne.nl

linkedin.com/company/  
at-osborne



## AT OSBORNE

The design of the living environment contributes significantly to the well-being of people. Examples are unobstructed mobility, a clean and safe environment, suitable accommodation and good healthcare. AT Osborne contributes to this with sustainable solutions. Our focus is on infrastructure, healthcare and sustainable living environment. Our motto is: 'Urban Matters, People Matter'.

At AT Osborne, large-scale projects are our bread and butter. Examples include the railway station area in Utrecht, the Zuidas business district in Amsterdam and the Amsterdam North-South Metro Line. We work for public clients, ministries, provinces, municipalities, care organisations, educational institutions and housing corporations.

What sets us apart is that we make connections, between parties involved, between plans and practice and between the customer and us. We are persistent, because we know from experience that there is a solution for every issue. No matter how far it sometimes seems to be found in daily, unruly practice. With our many talents, we are able to look from different perspectives. With over 150 specialists we work with our clients on the best results.



### AT Osborne investing in talent

We invest in our people. Especially in young talent. Starters are supported to combine work, education and research in our Young Osborne Program. They experience personal development in a short period of time and are given the opportunity to explore their own fields of interest. And all that in a challenging and varying work environment. AT Osborne is always looking for people who like a challenge. People with ambition, own initiatives and creativity.

Are you looking for a job in which you can contribute to socially relevant projects based on your knowledge and experience? Do you perform well in an environment that provides you with freedom and responsibility to pave your own way? Then we would like to meet you.

Interested in working at AT Osborne? Scan the QR-code to view available vacancies.





## Atriensis projecten

**Branch**  
Consultancy

**HQ Location**  
Eindhoven

**Employees**  
55



### Classification

- |            |        |
|------------|--------|
| ● AUDE (A) | ● SED  |
| ● AUDE (U) | ● USRE |
| ● BPS      | ● BT   |
| ● CME      | ● CT   |

**Contact person**  
Susan van den Boomen, HR

**Visiting address**  
Zemikestraat 17  
5612 HZ  
Eindhoven

☎ +31 40 7501520

✉ [s.v.d.boomen@atriensis.nl](mailto:s.v.d.boomen@atriensis.nl)

🌐 [atriensis.nl/portal-over-het-bedrijf/  
contact-eindhoven](http://atriensis.nl/portal-over-het-bedrijf/contact-eindhoven)

🌐 [linkedin.com/company/atriensis](https://www.linkedin.com/company/atriensis)



Atriensis projecten is a young and dynamic company. We support social housing associations with their challenges related to energy and sustainability.

Our advisory services focus on:

- Energy and sustainability policies
- Renovation projects
- Gathering and controlling real estate data
- Programs to stimulate and motivate conscious residents' behavior
- Advice on the implementation of new energy technologies

Atriensis projecten has a flat organizational structure. Due to continued growth, we offer many career possibilities for starters with different disciplines within the built environment. Atriensis projecten is an organization with passion for sustainability and a heart for social housing. Atriensis projecten operates throughout the Netherlands from offices in Eindhoven, Zwolle and Amstelveen. We work together with our sister company Atriensis data. Atriensis data focuses on gathering and controlling real estate data.

Employees of Atriensis projecten share a number of qualities:

- Social responsibility
- Customer orientation
- Integrity
- Reliability
- Fluent in Dutch



Atriensis was founded 16 years ago. On October 1st of 2018 we split Atriensis in two companies: Atriensis projecten and Atriensis data. Atriensis projecten is a young and dynamic company that supports social housing associations with their challenges related to energy and sustainability. We are a fun, informal company with a young and energetic team of colleagues. Atriensis projecten wants to motivate and fascinate their employees, establish a sustainable working relationship with them and ensure a good work-life balance. For example, Atriensis projecten provides a daily lunch, flexible working hours, working from home, a customized internal training program with around 70 – in company – courses and excellent working conditions with many possibilities to develop yourself!



Internship, graduation or your first job at Atriensis projecten? Interested in applying for a position with us? We have many (job) opportunities: internships, graduation projects and vacancies for starters and young professionals. For more information, please visit our website at [www.atriensis.nl](http://www.atriensis.nl) or sent us an e-mail: [werken@atriensis.nl](mailto:werken@atriensis.nl)

Interested in working at Atriensis projecten? Scan the QR-code to view available vacancies.



## Aveco de Bondt

**Branch**  
Engineering

**HQ Location**  
Holten

**Employees**  
400

### Classification

- AUDE (A)
- AUDE (U)
- BPS
- CME
- SED
- USRE
- BT
- CT

### Contact person

Michiel Berk, Recruitment

### Visiting address

Burgemeester van der Borchstraat 2  
7451 CH  
Holten

+31 6 23167690

mberk@avecodebondt.nl

avecodebondt.nl

linkedin.com/company/  
aveco-de-bondt



Aveco de Bondt is an independent agency that designs, researches and advises.

We connect knowledge areas, tasks, people and organisations. With specialist knowledge in the area of water, sustainability, infrastructure and construction, we devise smart, innovative and future-proof solutions for the ecological and social challenges that our clients face. We work for developing, building and managing companies and organisations, such as Public Works Department, water boards, provinces, municipalities, contractors and investors. We offer them solutions that are realistic and surprising and where sustainability and manufacturability come first. We are enterprising engineers and consultants with guts. We dare to innovate and come up with creative solutions. In this way, together with clients and partners, we create a positive impact on everyone's living environment.



Interested in working at Aveco de Bondt? Scan the QR-code to view available vacancies.





## B-invented B.V.

### Branch

Engineering and other technical design and Consultancy

### HQ Location

Eindhoven

### Employees

35



### Classification

- AUDE (A)    ● SED
- AUDE (U)    ● USRE
- BPS        ● BT
- CME        ● CT

### Contact person

Gijs Schalkwijk

### Visiting address

Achtseweg Zuid 153M  
5651 GW Eindhoven

+31 40 7805131

gijs.schalkwijk@B-invented.com

b-invented.com

linkedin.com/company/  
b-invented-b.v.



Building a better future together is possible if you don't see construction as a series of traditional actions, but as a process that can be optimized continuously.

We do that by manufacturable designing and engineering. We look at the process and match our ideas with those of our clients and subcontractors. In this way we can guarantee in advance that people, methods and resources fit together perfectly. The result is a construction process that runs smarter, more efficiently and carefree.

We currently do this with our 3 companies:

B-invented B.V. – Create  
B-smart funding B.V. – Foundate  
B-happy realisatie B.V. – Realize

We create, construct and realize buildings today with the solutions of tomorrow.

B-invented is our engineering firm for architectural- and structural engineering. Our approach is one that should suit you because we do it differently than other engineering firms. Our goal is to optimize the process of a total construction project. An optimal process gives maximum results and that's why we are driven construction improvers.



B-smart funding realizes the complete substructure: from piling to the ground floor. The necessary structural and constructive engineering is provided by our sister company B-invented. They combine their knowledge with the experiences of our permanent implementation teams. To optimize the process, we have developed products that make this possible, such as the B-smart and B-smart S elements and various prefab system components. Smart in the basics.

B-happy takes care of the architecture, engineering and realization for all types of construction: from industrial buildings and logistics complexes to offices, apartments and homes. We mainly work for professional clients. In addition, we develop innovative visions such as exclusive villas, vertical neighborhoods and visions for primary care centers and customized care homes. The construction is the proof.

Interested in working at B-invented B.V.? Scan the QR-code to view available vacancies.



## bbn adviseurs

### Branch

Consultancy

### HQ Location

Houten

### Employees

125

### Classification

- AUDE (A) ● SED
- AUDE (U) ● USRE
- BPS ● BT
- CME ● CT

### Contact person

Maaïke Bondrager,  
project manager

### Visiting address

De Molen 100  
3995 AX Houten

+31 88 2267400

info@bbn.nl

bbn.nl

linkedin.com/company/  
bbn-adviseurs



### Freedom to achieve your career goals

At bbn adviseurs, we work on many different types of projects, from real estate undertaking and urban regeneration to housing issues and construction initiatives.

We work not only for public institutions and governments, but also for commercial clients.

Our expertise is widely acknowledged. Among others, we employ project managers, planning economists, construction cost managers and real estate managers. Working in teams with all these disciplines, we take on challenging and noteworthy assignments.

bbn will give you every opportunity and all the freedom you require to fully develop your qualities. Our teams are a mixture of newly qualified people and those with many years experience. We regularly organise project visits, learning events and social events with young bbn. We are always on the lookout for talent to strengthen our teams. If this sounds like something for you, make sure you check the latest vacancies on our website [werkenbij.bbn.nl](http://werkenbij.bbn.nl) or feel free to contact us to discuss your possibilities.



Interested in working at bbn adviseurs? Scan the QR-code to view available vacancies.





## BESIX Nederland

**Branch**  
Contractor

**HQ Location**  
Dordrecht

**Employees**  
190



### Classification

- AUDE (A)    ● SED
- AUDE (U)    ● USRE
- BPS    ● BT
- CME    ● CT

### Contact person

Anita van Genderen, HR

### Visiting address

Laan van Europa 900  
3317 DB  
Dordrecht

+31 78 2062300

anita.vangenderen@besix.com

besix.nl

linkedin.com/company/  
besix-nederland



### Excel in creating sustainable solutions for a better world

BESIX Nederland (part of the BESIX Group) builds innovative, trend-setting and complex projects in the civil concrete construction and the specialist utility construction in the Netherlands. We build projects such as the Sluishuis in Amsterdam, the Groene Boog (A13/A16) and the POST in Rotterdam, the Grotius Toren in The Hague and the new wooden hybrid head quarters for the DPG Media in Amsterdam.

Our extensive experience and expertise gives us the courage to think bigger. Together we stand for five values: Excellence, Co-creation, Respect, Passion and Unity. Our projects are realised by an ambitious team of passionate professionals who won't shy away from a challenge.

In short: do you want to work on realising challenging and trend-setting projects in the Netherlands? Get in contact with us. We would love to tell you more about BESIX and our possibilities!



Interested in working at BESIX? Scan the QR-code to view available vacancies.



## BiermanHenket

**Branch**  
Architecture

**HQ Location**  
Esch

**Employees**  
30

### Classification

- AUDE (A)    ● SED
- AUDE (U)    ● USRE
- BPS    ● BT
- CME    ● CT

**Contact person**  
Joep van As

**Visiting address**  
Hal 13A  
5296 PZ  
Esch

☎ +31 411 601618

✉ info@biermanhenket.nl

🌐 biermanhenket.nl

🌐 linkedin.com/company/  
biermanhenket



## BiermanHenket

architectuur | interieur | restauratie | techniek

BiermanHenket architecten is specialised in the restoration, transformation and extension of existing - often listed - buildings. In addition, we create new buildings which fit naturally into a town or neighbourhood. It is our aim to create surprising buildings and interiors where people can move around comfortably and which encourage people to meet. We bring historical awareness to our work, building upon the layered city architecture. In doing so, we strive for the highest quality of architecture which adjusts naturally to its use, but which at the same time leaves room for change.

### Approach

We are happy to take on projects of all sizes, from a town-planning scheme to a single building or interior design. Each assignment is unique and starts with intensive consultations and an analysis of requirements and preferences. If required, we will produce a design brief. We will carry out an analysis of the history and values of the site. The design stage will produce variants so that we can work with stakeholders to arrive at optimally supported decisions. Three-dimensional BIM models are used from the start of the design process, producing a kind of digital prototype of the building. This enhances the visibility for all stakeholders, as it is easier to imagine the expected result. We find it important that there is a good design and building process, where all partners play an equal part - client, users, advisers and performing parties. This is the essence in achieving a high-quality, sustainable design that matches the pre-set building budget. During this process, we aim to design in an integrated way, encompassing space, time and budget.



### Sustainability

We believe in progress and want to pass on a cleaner world to future generations. It is our aim to construct healthy and flexible buildings, where people can move around optimally and which encourage people to meet. We believe in a future based on circular and bio-based construction. Using functional blending and circularity, we reduce carbon emissions, water use and waste.

### Technology

We aim for careful choice of materials and detailing of our buildings. Building designs are worked out with the greatest care and attention to the tiniest detail. Sustainability and makeability are important principles for us. Integration is a key goal: constructions, building engineering and systems are dovetailed to function smoothly as a totality, whilst always aiming for simplicity in technology.

### BIM

In order to improve integral alignment, BiermanHenket works out its projects in a Building Information Model (BIM). In consultation with clients and project partners, the necessary information for the design, building and/or maintenance stages is determined for each project. The national BIM-based ILS standard is used as a starting point.

BiermanHenket continually works on improving its work processes, to enable it to respond to new developments. The firm is leading the way in applying BIM to the renovation and transformation of existing buildings. BIM is used, amongst other things, to specify and record the monumental values of a building.

Interested in working at BiermanHenket? Scan the QR-code to view available vacancies.





# BIM-Connected

**Branch**  
Information technology and services

**HQ Location**  
Eindhoven

**Employees**  
15



**Classification**

- AUDE (A)    ● SED
- AUDE (U)    ● USRE
- BPS        ● BT
- CME        ● CT

**Contact person**  
Jakko Heinen, Founder/Managing partner

**Visiting address**  
Torenallee 62-66  
5617 BD Eindhoven

+31 40 2201943  
jakko.heinen@bim-connected.com

bim-connected.com

linkedin.com/company/  
bim-connected



For your complex digital asset management issues

We love to help people through creative, smart and value-adding IT solutions. We want smart IT ecosystems in which data is entered once and used multiple times. After which it is displayed in the correct way in other systems, in the right place within and outside the organisation. Combining the right person with data at the right place can ensure a focus on the creative and smart use of data to achieve business goals. We want that for everyone! Whether it is called information management, BIM or SE, a combination, or something else, does not matter to us. We see that Linked Data and Knowledge Graphs are able to really allow you to take control of your data; therefore we have become proficient in this.

The industries in which we operate are the construction, infrastructure and energy industry. There, many organisations work in several (project)phases on the largest and most complex projects, where it is rare that data is only relevant for one party. We are ready to help and solve these challenges. We are active in the entire spectrum from data to wisdom: from drawing up the data schemes to developing and implementing a new robust and future-proof method. Making data valuable!



**Our vision**

Society has unprecedented technical possibilities. It is in the interest of all of us that the realisation and maintenance of the largest systems for transport, energy and construction works remain affordable and of high quality. Given the importance of the right information at the right place, the software parties should work together to facilitate business in practice. This happens, thankfully, and the infamous vendor lock-in will lose to collective partnership. However, the battle is not over yet, a continuous collaboration between the users and the software independent IT workers is required. After all, the technology alone is not enough. There is a bridging function to be fulfilled between the multidisciplinary work processes, determining and obtaining the management information and the use of IT technology. We facilitate this bridging function with the specialisation in IT technology and with domain knowledge of our industries.

**Our mission**

The rewards of digitalisation and automation can be reaped by those who master the technology. We have this expertise and can act as an extension of any organisation. We support clients and contractors in our industries to collectively achieve a higher level of capturing and exchange of information. We are fans of transcending organisational standards. With a good dose of humour, fighting spirit and substantive knowledge, we take our clients on a journey! And yes, a lot of stories can be told of our travels in tackling the legacy and implementing new ways of working. With perseverance, substantive discussion, sometimes a bit of politics and openness to new insights. We are happy to contribute our (digital) bit to really solving asset management issues and think it is great to witness the developments in our markets!

Interested in working at BIM-Connected? Scan the QR-code to view available vacancies.



# Blitta Gevelsystemen

## Branch

Facade construction

## HQ Location

Venray

## Employees

125



## Classification

- AUDE (A) ● SED
- AUDE (U) ● USRE
- BPS ● BT
- CME ● CT

## Contact person

Sanneke Kettenis, Sales

## Visiting address

Maasheseweg 77  
5804 AB  
Venray

+31 6 21851817

s.kettenis@blitta.nl

blitta.nl

linkedin.com/company/blitta



Since its foundation, Blitta has been strongly focused on innovation. With our knowledge, experience and creativity, we offer architects, construction companies and project developers total solutions for the design and construction of facades. As co-designer and co-maker, we are happy to take responsibility for the entire facade. Our engineers work closely with architects about whether and how an image-defining design can be made. Our specialists in the production area search for the best method for producing and assembling the facade elements for every project. We are continuously investigating how we can make a sustainable contribution to a pleasant living climate inside and outside a building by incorporating new technical functionalities in our facade systems.



Interested in working at  
Blitta Gevelsystemen?  
Scan the QR-code to view  
available vacancies.





# BREED Integrated Design

## Branch

Architecture and Structural design

## HQ Location

The Hague

## Employees

10



## Classification

- AUDE (A) ● SED
- AUDE (U) ● USRE
- BPS ● BT
- CME ● CT

## Contact person

Jeroen Evers, Management board

## Visiting address

Korte Koedliefstraat 6/8  
2511 CE  
The Hague

+31 70 7852944

info@breedid.nl

breedid.nl

linkedin.com/company/  
breed-integrated-design



BREED Integrated Design is a structural design firm that considers that structure is more than a functional part of the architectural design. It can play an important role in the spatial experience. Structure can enrich the space, indicate scale and provides an aesthetic quality. In this way it is a design 'tool' and inherent to the architectural space. BREED ID likes to be actively involved in the design process at an early stage, to provide structural alternatives in order to look for an optimal result together with the architect and other design team members.

BREED Integrated Design was founded in 2006 by Gilbert van der Lee (1973) out of a predilection for the tension between structural engineering and architecture. Gilbert was the first student at TU/e to graduate in both masters 'Architecture' and 'Structural Design'. Later he also completed the study Master City Developer (MCD). In 2019 Jeroen Evers (1987) joined the management team. Jeroen has successfully completed a dual master track at TU/e in which he combined the masters 'Architecture' and 'Structural Design'. Gilbert and Jeroen work together with their team of engineers and architects on high-profile projects in The Netherlands and abroad. The projects are of all sizes; from artworks to high-rise buildings, from villas to monkey residences, but also non-residential buildings and bridges. Below you'll find a selection of projects we are particularly proud of.



Villa 1 (in collaboration with Powerhouse Company) is a wonderful example of a project where structure and architecture are integrated. An important structural element in this villa is an open steel bookcase that supports and stabilizes the roof. For this, the bookcase is designed as a 'Vierendeel' truss. As a result, the roof, with large overhangs, appears to be largely floating. Not the closed end wall, but the bookcase, kitchen and the other permanent furniture do the work.

TIJ (in collaboration with RO&AD, RAU and Geometria) is a bird observatory in the shape of an egg. The egg is parametrically designed to find a good balance between architectural wishes and structural requirements. The structure is formed by a Zollinger system. As a result, large, double-curved spans can be made with wood. The Zollinger system is an old construction technique that can be applied again through digitization and automation. Through its reusability, its modularity, its materials and its contribution to the natural environment, it is almost completely circular and sustainable.



The Bahrain pavilion, World Expo 2015 in Milan, (in collaboration with architect Anne Holtrop, landscape architect Anouk Vogel and Mario Monotti) is made up of 350 unique, white, partly curved prefabricated concrete panels. The starting point in the design was a pure appearance of dry-stacked concrete. It was a big technical challenge to design a demountable, earthquake-resistant, reusable minimalist pavilion. The pavilion can now be visited in Bahrain.

We are a small firm with very challenging projects. If you like to develop further as an allround structural engineer / integral structural designer / table football player, visit our stand at the TU/e Bouwkunde Bedrijvendagen!

Interested in working at BREED Integrated Design? Scan the QR-code to view available vacancies.



## Brink Management / Advies

**Branch**  
Consultancy

**HQ Location**  
Rotterdam

**Employees**  
175



### Classification

- AUDE (A)    ● SED
- AUDE (U)    ● USRE
- BPS    ● BT
- CME    ● CT

### Contact person

Annemieke Hamakers, HR

### Visiting address

Stationsplein 45  
3013 AK  
Rotterdam

☎ +31 6 54606019

✉ a.hamakers@brink.nl

🌐 [brink.nl](https://www.brink.nl)

🌐 [linkedin.com/company/brink-nl](https://www.linkedin.com/company/brink-nl)



# BRINK

Get with us into the middle of construction, infrastructure and real estate! From the heart of the market we keep a 360° eye on all changes in the market with our management- and consultancy services, software and financial solutions. Together with our clients we search for the literal edges of the possible.

We started this in 1972 and ever since we've grown to 250 men and women strong. Everyone with its additional speciality. Because at Brink we work together. With the most diverse clients and partners. With especially a lot of data. With a lot of solution-oriented ability. For a diversity of cases. In the heart everything comes together. And in the heart stands Brink. Beating heart of construction, infrastructure and real estate.



Interested in working at  
Brink Management/Advies?  
Scan the QR-code to view  
available vacancies.





## Bulsink Group

**Branch**  
Construction

**HQ Location**  
Son en Breugel

**Employees**  
60

### Classification

- AUDE (A) ● SED
- AUDE (U) ● USRE
- BPS ● BT
- CME ● CT

**Contact person**  
Sanne van Grinsven, HR

**Visiting address**  
Ekkersrijt 7005  
5692 HB  
Son en Breugel

☎ +31 6 12810380

✉ [hr@bulsink.nl](mailto:hr@bulsink.nl)

🌐 [bulsink.com](https://bulsink.com)

🌐 [linkedin.com/company/  
bulsink-retail-bv](https://www.linkedin.com/company/bulsink-retail-bv)



Bulsink is a leading organization when it comes to the design and the super-fast realization of retail, hospitality, leisure, office and care concepts. With a young, innovative, decisive organization, we ensure that the entire building process continues to grow.

The core values establish the DNA of the company. Bulsink is a brand and not a traditional construction company. By being brand aware, they build brands with customers and the 'Bulsink' brand. Bulsink always thinks in the customer's perspective, this can work in a supporting position of directly working with the customer. The customer needs are always central. Operational excellence makes the organization agile. Without making any agreement, they guarantee the quality. The customer is being inspired and surprised by proactivity and efficiency that the company offers to the customers.

To build faster, better and at a lower cost, advanced digital tools are used throughout the building process. By using new technologies, such as 3D design, virtual reality and augmented reality, processes can be organized and coordinated differently. By applying these innovative construction techniques, drawings can be brought to life with VR and AR visualizations.



Webcams are also installed on the construction site to monitor the progress of projects. Bulsink uses sophisticated technologies such as cameras on site, digital scrum boards and a secure online project platform with the possibility of real-time consultation anywhere in the world.

Bulsink is growing strongly internationally. With teams in several European countries, the company remains well aware of the relevant local laws and regulations. This makes it possible to act quickly on projects abroad. Additionally there is one point of contact for all national and international branches.

In a constructive way we look at how the appearance of a concept can be realized constructively. How this can be done as quickly as possible and how this can be done in a way that is reproduced retroactively at existing locations. Major brands choose Bulsink because the company is very aware of the importance of uniformity.

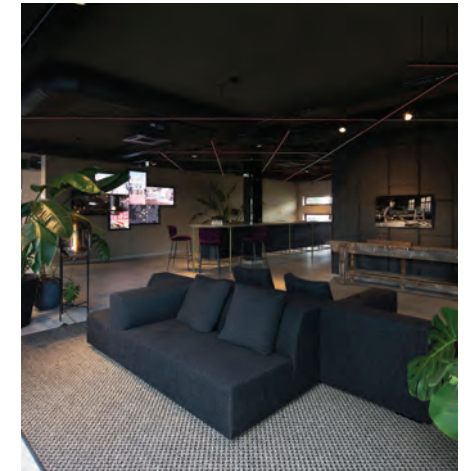

By taking care of complete construction projects, from start to finish. Even if it concerns several projects at the same time, or projects across the border, Bulsink will support in the search for solutions and for new possibilities.

The aspect of experience is important, and the company's extensive experience ensures that Bulsink is the right party to put large projects into practice. The need for experience shapes the repurposing and redevelopment of buildings. When it comes to housing, organizations have to constantly rethink, switch and convert. The need for a single point of contact is greater than ever. Bulsink is the point of contact for branches at home and abroad. Whatever ambitions you have, Bulsink helps to realize them.

Bulsink. We get things done.

Interested in working at Bulsink? Scan the QR-code to view available vacancies



## Branch

Commercial real estate

## HQ Location

Amsterdam

## Employees

600



## Classification

- AUDE (A)    ● SED
- AUDE (U)    ● USRE
- BPS    ● BT
- CME    ● CT

## Contact person

Valérie van der Kloot Meijburg

## Visiting address

Anthony Fokkerweg 15  
1059 CM  
Amsterdam

+31 20 6262691

nlrecruitment@cbre.com

cbre.nl

linkedin.com/company/  
cbre-nederland



# CBRE

With over 90.000 employees spread over 500 offices in 100 countries, CBRE is global market leader in real estate consultancy. In the Netherlands our 600 professionals work each day on the most exciting real estate projects from our offices in Amsterdam, The Hague, Eindhoven, Rotterdam, Utrecht and Zwolle.

CBRE is an organization where it does not matter if you are an experienced professional or a young talent or which position you hold. We offer everyone the freedom to identify and seize opportunities. We work hard for our successes and also celebrate these with each other, for example, after closing a deal or during our weekly drinks.

Since the beginning of 2019 CBRE has a new headquarters in the Schinkelbuurt in Amsterdam, named The Core.

A new, innovative office under a 50-year-old roof in an old car garage. With this office we take a new path, we give entrepreneurship the space it needs, and we work closer together with our clients.

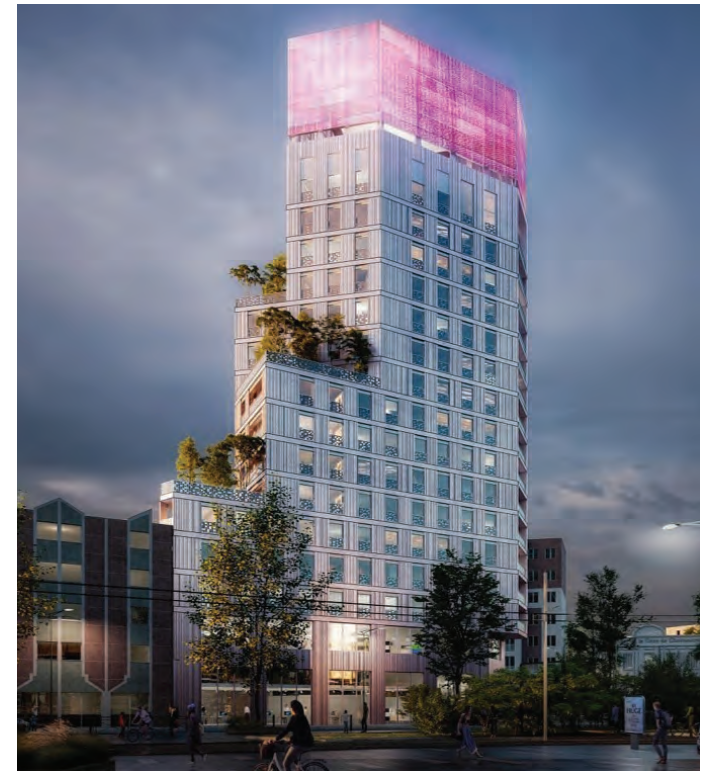

Interested in working at CBRE? Scan the QR-code to view available vacancies





## Count & Cooper

### Branch

Infrastructure and Project management

### HQ Location

Rotterdam

### Employees

65

### Classification

- AUDE (A)
- AUDE (U)
- BPS
- CME
- SED
- USRE
- BT
- CT

### Contact person

Sven Meeusen

### Visiting address

Stationsplein 45 unit A7.194  
3013 AK  
Rotterdam

+31 6 82737202

meeusen@countcooper.nl

countcooper.nl

linkedin.com/company/  
count-&-cooper



# COUNT & COOPER

## BUILDING NEW WAYS

### If you do what you did, you get what you got

The construction world has known and has been saying for more than twenty years that it must change radically. Our society is imposing increasingly higher demands on infrastructure and building plans. As a result, the old, familiar way of working is simply not good enough anymore. Quite frankly, however, very little changes in practice. And that is not because parties do not want to change, it is because they do not really know how to. In other words; the construction world needs an outside impulse. A company that thinks from different conventions and uses new technologies. A company that does not pose a threat, but is a strong asset. That company is Count & Cooper.

### Making an impact by what we don't do

The world's largest taxi company does not have its own cars. And the world's largest hotel chain does not actually have its own rooms. These are nextgen companies that simply bring parties together and use technology to do this as efficiently, reliably and profitably as possible. Game changers. And that is exactly how we make an impact; we are the builder who does not build.

### A catalyst for change

Driving change, that's what we do. Transform and renew. Where others see problems, we see opportunities for further growth as a company. We are driven by results, make an impact and ensure win-win situations for everyone. We are not just going to reinvent the construction world, we are going to do that together with them.

Count & Cooper is the independent consortium partner that speeds up this process, boosts productivity and makes the end product more predictable.

"We change the way how projects are delivered." That's what we like to do most.

Imagine, that all the information collected over the years, and stored in all the different construction sheds, would be stored in one place. So you can learn from the past and not make the same mistakes in the future as before. By linking data, we gain more extensive insights into our projects and how we can better manage them. From budget to manpower, from environmental work to seasonal influences. It's one of the ways in which Count & Cooper, together with its partners, is reinventing construction. Making it more efficient, more predictable and more sustainable.



Interested in working at Count & Cooper? Scan the QR-code to view available vacancies.



# Dura Vermeer

Branch  
Construction

HQ Location  
Rotterdam

Employees  
2800



## Classification

- |            |        |
|------------|--------|
| ● AUDE (A) | ● SED  |
| ● AUDE (U) | ● USRE |
| ● BPS      | ● BT   |
| ● CME      | ● CT   |

Contact person  
Patricia Chaudron

Visiting address  
Pettelaarpark 1  
5216 PC  
's-Hertogenbosch

+31 6 55250093

p.chaudron@duravermeer.nl

[duravermeer.nl/dura-vermeer-bouw-zuid-bv](https://www.duravermeer.nl/dura-vermeer-bouw-zuid-bv)

[linkedin.com/company/dura-vermeer](https://www.linkedin.com/company/dura-vermeer)



## Dura Vermeer at a glance

Dura Vermeer is a family owned construction company operating throughout the Netherlands which, with a turnover of more than €1.44 billion and some 2,800 employees, counts among the top of the Dutch construction market. Dura Vermeer was founded in 1855 and has a focus on long term continuity and long term relationships with her most important stakeholders.

We are active in the residential construction, non-residential construction, infrastructure and rail market segments. Our core activities are the development and realisation of our own newbuild projects, maintenance and renovation.

Dura Vermeer chooses to focus on projects that are a good match with the company in terms of size, experience, expertise, general risk profile and financial capacity, and where we can stand out from our competitors. Our ambition is to be one of the top three innovating and most successful companies in the construction industry.



## CSR and sustainability

Dura Vermeer subscribes to the view that proper and responsible business practices are a precondition for building trust and thus for the continuity of the company.

The CSR and sustainability policy focused in the following issues:

- Safety
- Integrity
- Employees
- Waste
- Reducing carbon emissions
- Customer satisfaction
- Innovations
- Supply chain partnerships

## Dura Vermeer Bouw Zuid

Dura Vermeer Bouw Zuid is one of the operating companies located in 's-Hertogenbosch. With a turnover of €110 million and 115 employees, this operating company is responsible for the development and construction of new buildings (residential & non-residential) in the area Brabant, Limburg, Zeeland.

Interested in working at Dura Vermeer? Scan the QR-code to view available vacancies.





## Ector Hoogstad Architecten

Branch  
Architecture

HQ Location  
Rotterdam

Employees  
50

### Classification

- AUDE (A)    ● SED
- AUDE (U)    ● USRE
- BPS    ● BT
- CME    ● CT

### Contact person

Rianne Pape, PR & Officemanager

### Visiting address

Hofplein 20  
3032 AC  
Rotterdam

+31 10 4402121

r.pape@ectorhoogstad.com

ectorhoogstad.com

linkedin.com/company/  
ector-hoogstad-architecten-b-v-



## Ector Hoogstad Architecten

Pioneering architecture for an ever better future – that is the goal of Ector Hoogstad Architecten. We make spatial designs on all scale levels for various types of clients, with knowledge landscapes as a basic theme. We are experts in creating environments that make people excel together in knowledge processes. In close collaboration with all stakeholders we come up with remarkable designs in all respects; architecture, technology, sustainability, flexibility, future value, and so on. We do not shy away from complexity – it just makes us more determined.

EHA was founded in 1959 by Jan Hoogstad (1930-2018), who learned the trade during the post-war reconstruction of Rotterdam by working for major Dutch modernists such as Maaskant. Numerous remarkable buildings still bear witness of his rich oeuvre. Sixty years later, EHA has grown into a diverse and talented team of over fifty design and management professionals, led by five partners: Joost Ector, Gijs Weijnen, Max Pape, Chris Arts and Koen Klijn. In 2018, the office relocated to the top floor of the iconic and bustling Hofpoort (the former "Shell Tower") on Hofplein in the heart of Rotterdam.



As a full service architectural firm we operate just as easily within a traditional project organization as in innovative variants where we participate in larger consortia or act as total engineer. The core of our design philosophy is a firm belief in integral collaboration based on knowledge, creativity and experience, that takes place on all levels: with clients and end users, with design consultants and with building partners.

That is why we constantly invest in tools and skills for excellent communication. Together we can produce better ideas, smarter solutions and optimal support. This is how we deliver maximum added value – for society, for the end users of our buildings and for our clients.

Interested in working at Ector Hoogstad? Scan the QR-code to view available vacancies.



## EGM architecten

**Branch**  
Architecture

**HQ Location**  
Dordrecht

**Employees**  
120



### Classification

- AUDE (A)    ● SED
- AUDE (U)    ● USRE
- BPS    ● BT
- CME    ● CT

### Contact person

Els Janse, HR manager

### Visiting address

Wilgenbos 20  
3311 JX  
Dordrecht

☎ +31 78 6330618

✉ [els.janse@egm.nl](mailto:els.janse@egm.nl)

🌐 [egm.nl](http://egm.nl)

🌐 [linkedin.com/company/  
egm-architecten](https://www.linkedin.com/company/egm-architecten)



EGM architects is one of the largest architectural agencies in the Netherlands. We are a national and internationally active architecture office, with about 120 employees, based in Dordrecht (near Rotterdam).

EGM architects works on various assignments as well in the Netherlands as abroad; from healthcare to commercial real estate, from small to very complex designs, from structural plans to interior projects. In addition, a building is never isolated but always part of society. EGM architects is one of the few offices that provides a full range of services in design, detailing and construction. We are therefore able to oversee large, complex projects using our own resources. Our combination of architects, advisors, interior designers, BIM specialists and R&D specialists ensures that you become a member of an exceptionally broad team of experts who are passionate about their work. We work on a wide range of projects, among others in the Netherlands and also in Curaçao, Finland, Korea, Suriname, Saudi Arabia and Slovakia, with a focus on complex social assignments in the health, government and industry sectors.



### Internship and vacancies

You are following an architectural education at the University of Technology and you have an affinity with healthcare architecture and other complex problems. You are curious and have an inspiring view of socially driven architecture.

An important aspect of our work is telling stories with imagination. You are therefore familiar with all the ins and outs of software programs like AutoCAD, 3ds Max, Rhino, Revit and Adobe Creative Suite. You are at least 6 months available for five days a week.

We offer an inspiring and informal environment in which you will master all aspects of a design project within a short period of time. You work closely with one of our project leaders and are full member of the project team. This way you will get to know all facets of the design process. At the same time, we offer plenty of possibilities for personal development.

Interested in working at EGM? Scan the QR-code to view available vacancies.





# Goudstikker - de Vries

## Branch

Construction

## HQ Location

's-Hertogenbosch

## Employees

70



## Classification

- AUDE (A) ● SED
- AUDE (U) ● USRE
- BPS ● BT
- CME ● CT

## Contact person

Wessel Manders

## Visiting address

Stadionlaan 81  
5213 JJ  
's-Hertogenbosch

+31 88 6780530

w.manders@goudstikker.nl

goudstikker.nl

linkedin.com/company/  
goudstikker-de-vries-b.v.



At Goudstikker-de Vries we offer you a working environment in which you can excel. We are an ambitious team, with a treasure of knowledge about engineering. Knowledge that we are happy to pass on to you. Whether you work as a consultant, constructor or BIM-specialist, your knowledge and experience contribute to achieving the best possible result. We go to great lengths to understand our customer's wishes.

A collaboration always starts with the design in mind. Together we create value by offering constructive and architectural solutions.

Our 'architectural heart' beats faster when it comes to constructive challenges or complex works in difficult locations. The requirements we set for our work require certain competencies that we are looking for in new colleagues.

What you deliver will soon be visible in a city, village or residential area. Not just for yourself, but for everyone. Users, residents or passers-by, everyone looks at beautiful buildings and creative constructions with admiration and respect, right? At Goudstikker-de Vries you get the chance to participate in this. This only makes our work more fun and interesting. Working at Goudstikker-de Vries means challenging work, good career opportunities and excellent employment conditions. With us you become part of a team of professionals and within this we value every individual. We create an environment that ensures that you can enjoy your work every day and achieve your personal goals.



If regular working from home suits you better because of the travel time, then that is possible. Just like using parental leave because you have or will have a busy family life. We are happy to think along with you about the employment contract that best suits your current stage of life. We are involved with each other.

Our lively staff association organizes fun activities and anniversaries and of course keeps all important events in its sights. Think for example of birthdays, moving house, weddings or the birth of a baby. Personal milestones deserve extra attention and should be celebrated.

From day one, we offer you plenty of room for your development within Goudstikker-de Vries, where you will receive excellent guidance. We pay a lot of attention to the development and training of our employees in order to continue to guarantee the quality of our work.

We work on this through a training, course or education. This makes it possible to continuously immerse yourself in your field, to develop yourself and to work on your career opportunities. Regardless of your knowledge or experience level.

With our Young-Professionals Program we offer an additional internal training program through informative lunch lectures, sharing knowledge and experiences or visiting a construction site. Together we discover what you are good at and what you like to do. A long-term and pleasant working relationship is created by letting you do the work that suits you best.

If you would like some more information or want to have a little chat please contact us!

Interested in working at  
Goudstikker - de Vries?  
Scan the QR-code to view  
available vacancies.



## Branch

Construction and Infrastructure

## HQ Location

Rosmalen

## Employees

5000



## Classification

- AUDE (A)    ● SED
- AUDE (U)    ● USRE
- BPS    ● BT
- CME    ● CT

## Contact person

Elisa de Klerk

## Visiting address

Graafsebaan 65  
5248 JT  
Rosmalen

+31 6 50179747

eklerk@heijmans.nl

heijmans.nl

linkedin.com/company/heijmans



Heijmans is a versatile company in which real estate, housing, utilities (construction, mechanical engineering and electrical engineering) and infrastructure (roads and civil engineering) work together. Do you want to contribute to the contours of the Netherlands? Then come work at Heijmans and build projects like highways, universities, bridges, hospitals and apartment complexes. Our projects are located across the country. Think for example of the A1 between Apeldoorn and Azelo or the build of Amsterdam Vertical in Sloterdijk. But, we also do projects of a smaller scale, like het Straatje in Delft or the new student housing on the TU/e campus.

Within Heijmans you are contributing to the entire process of realizing a project. From engineering to realization to the maintenance. Through this you can see what goes into building the project and how it is utilized. That is what makes working at Heijmans divers and super interesting. With approximately 4500 colleagues, you can build the spatial contours of tomorrow with us. Together we create beautiful projects of lasting value, for our customers and for society. It determines our success.



Do you want to become a part of that? Heijmans offers a range of opportunities to develop and challenge yourself. You can do an internship in the field of BIM, circularity, realization, engineering, tender management, client management or construction. We also offer a traineeship in which you can get a taste of everything Heijmans has to offer and at the same time follow a training program for a flying start to your career.

The diverse projects that Heijmans develops and realizes provide an ideal environment in which to put your knowledge into practice. Whether it concerns a hospital, a school building, homes, offices or shops, a highway with tunnels, viaducts and technical installations or an entire neighborhood.

We give you the space to discover what your ambition is, what you can do and what suits you.

And we offer you the guidance and facilities that you can expect from a professional company. So that you can make optimal use of your talents and possibilities.

Heijmans would like to get to know you and your talent!

Interested in working at Heijmans? Scan the QR-code to view available vacancies.





# Koninklijke BAM Groep

## Branch

Construction and Technology

## HQ Location

Bunnik

## Employees

9000



## Classification

- |            |        |
|------------|--------|
| ○ AUDE (A) | ● SED  |
| ○ AUDE (U) | ● USRE |
| ○ BPS      | ● BT   |
| ○ CME      | ● CT   |

## Contact person

Suzanne Haartman

## Visiting address

Runnenburg 9  
3981 AZ  
Bunnik

+31 6 31944239

stage@bam.com

bam.com

linkedin.com/company/  
bambouwentechniek



BAM Bouw en Techniek focuses on the commercial and technical development, preparation and construction of non-residential construction projects in the Netherlands and they also offer extensive services in the field of technical installations. They realise accommodation solutions that are flexible in terms of function, space and use. This ensures that the building and the installations are ready for the changing function and technology of the future.

BAM Residential combines the activities of area and property development, residential construction, making existing housing more sustainable and renovating it. They also provide individual support for residents to make their house a real home. AM, BAM Wonen and Homestudios are part of BAM Residential.

BAM Specials brings together many innovative and specialised activities in the field of construction and property. This company incorporates the business units BAM Energy Systems, BAM Modulair, BAM Materieel, BAM Industrie, Interflow, Schakel & Schrale, Bouwbedrijf Pennings, b.Home and Houtindustrie Stam & Landman



Interested in working at  
Koninklijke BAM Groep?  
Scan the QR-code to view  
available vacancies.



## Laanbroek Schoeman adviseurs & draaijer+partners

### Branch

Construction and Real estate and  
housing

### HQ Location

Utrecht

### Employees

80



### Classification

- AUDE (A) ● SED
- AUDE (U) ● USRE
- BPS ● BT
- CME ● CT

### Contact person

Yolanda Nout

### Visiting address

Jan Leentvaarlaan 25  
3065 DC  
Rotterdam

+31 30 6592333

info@lsadviseurs.nl

lsadviseurs.nl

linkedin.com/company/  
lsadviseurs



draaijer+partners

powered by the DraaijerGroup

### Strategic and organization-oriented housing

LSa and draaijer+partners are part of the Draaijer Group, a group of cooperating organizations. The common goal of the partners is to create, realize and exploit energetic and future-proof working and living environments. Together with their clients, the partners of the Draaijer Group work to create environments in which people feel comfortable and perform optimally.

LSa is the specialist in the field of organization-oriented housing.

This means that we pay attention to the organization itself, the people who work there and their environment. Things that are constantly changing. Housing rarely matches up seamlessly at all times with what the organization does or with what the people in an organization need.

Our task is to supervise that process and to ensure that it all works out the way our customers want it to.

draaijer+partners is a strategic partner in the field of housing. draaijer+partners believes in office buildings that encourage meetings and cooperation, in healthcare environments that contribute to faster patient recovery, and in schools that lead to better student and teacher performance.



That is why we provide buildings with a minimal ecological footprint that people love to visit.

The team of LSa and draaijer+partners consists experts in various fields.

The combination of these fields of expertise makes us a dynamic team with a considerable amount of experience and knowledge about strategic and organization-oriented housing.

We look at issues from different (integral) perspectives and know how to find an answer to every problem.

### Inspiring work environment

Are you looking for an inspiring working environment that gives energy and enables you to get the best out of yourself? LSa and draaijer+partners are growing continuously, which is why we have various challenging vacancies. Also we regularly work with (graduation) interns. We believe it is important that young talent can develop with us and we therefore try to give them a broad insight into the various possibilities within the world of construction and real estate.

We are proud of who we are and what we do. We enjoy working together in an open and innovative atmosphere. We do this flexibly, in terms of time, place and working hours. Our high-end ICT facilities and communication tools support this way of working. Freedom and responsibility are on top of our agenda. We pay active attention to your personal and professional development; that goes without saying and is actually our most important employment condition. Part of your personal development program is the Talent Management Analysis method, which focuses on your talents.

The Draaijer Group companies like to work together, give each other energy and strengthen each other wherever possible. We know how to make optimum use of each other's strengths.

Interested in working at  
LSa & draaijer+partners?  
Scan the QR-code to view  
available vacancies.





**Branch**  
Engineering and Consultancy

**HQ Location**  
Nieuwegein

**Employees**  
110



## Classification

- AUDE (A)    ● SED
- AUDE (U)    ● USRE
- BPS    ● BT
- CME    ● CT

**Contact person**  
Michelle van de Poll

**Visiting address**  
Kelvinbaan 40  
3439 MT  
Nieuwegein

+31 30 2311377

[info@lbpsight.nl](mailto:info@lbpsight.nl)

[lbpsight.nl](http://lbpsight.nl)

[linkedin.com/company/lbp-sight](https://www.linkedin.com/company/lbp-sight)



# LBP|SIGHT

LBP|SIGHT provides engineering and consultancy services. Our main focus areas? Construction, space and environment. Our consultants and specialists in building acoustics, building physics, fire safety, sustainability, energy, area development, noise and vibrations, environment, estate management and spatial planning work closely together. From sound research to daylight calculation. From valuation to license application. And everything in between.

## Our vision: 'Samen voor de leefomgeving'

A safe, healthy and sustainable environment for everyone, we believe it can be done. But to shape our future living environment, designers, executors, urban planners, architects and engineers must join forces. Only by combining knowledge and expertise, will we be able to make an impact in the long run.

## Working atmosphere

The working atmosphere at LBP|SIGHT is informal. We work together closely, which leads to professional and personal connections. Professional growth of all employees is high on our agenda. We encourage you to fulfil your potential, for example by attending our LBP|BRIGHT academy, which offers a mix of professional and more personal programmes.



## Are you ready to kickstart your career?

At LBP|SIGHT, you'll actively participate in client projects from the start, because we are a firm believer of 'learning by doing'. To optimally empower you, we'll make sure a colleague mentors you during your first year. Last but not least, our YOUNG LBP|SIGHT department organises formal and informal activities for colleagues under 32 years old and with less than five years of working experience within our company. The goal? To strengthen your bond with colleagues and our organisation. And to make you feel at home!

Interested in working at LBP|SIGHT? Scan the QR-code to view available vacancies.



## MVSA Architects

**Branch**  
Architecture

**HQ Location**  
Amsterdam

**Employees**  
70



### Classification

- AUDE (A)    ● SED
- AUDE (U)    ● USRE
- BPS            ● BT
- CME           ● CT

### Contact person

Gilan Beune, Marketing & PR

### Visiting address

Moermanskade 600  
1013 BC  
Amsterdam

☎ +31 20 5319800

✉ info@mvsa-architects.com

🌐 mvsa-architects.com

🌐 linkedin.com/company/  
mvsa-architects



# MVSA Architects

MVSA is an award-winning international full service architecture and design firm with offices in the Netherlands and Switzerland. Our mission is to create value for now and the future by maximising the potential of every project. We plan, build and design seamless environments that add functional and emotional value for those who use them, enrich their surroundings, promote sustainability and help companies to succeed.

MVSA creates innovative and exciting architecture, future-proof and sustainable, within schedule and budget.

At MVSA, we believe that every building should improve the lives of those who use it, while adding quality to the environment. Our solutions are the result of a collaborative, integrated design approach that embraces the entire architectural process, from first sketch to final detailing. We base each and every design on the functional needs of our client, the specific context of the project and the highest standards of sustainability.

Our goal is always to mix this pragmatism with architectural poetry, to improve the quality of life of the built environment.



Interested in working at MVSA? Scan the QR-code to view available vacancies.





# Nieman Raadgevende Ingenieurs

**Branch**  
Engineering and Consultancy

**HQ Location**  
Utrecht

**Employees**  
150



## Classification

- AUDE (A)    ● SED
- AUDE (U)    ● USRE
- BPS    ● BT
- CME    ● CT

**Contact person**  
Tamara Cevahir, HRM

**Visiting address**  
Atoomweg 400  
3542 AB  
Utrecht

☎ +31 30 2413427

✉ info@nieman.nl

🌐 nieman.nl

🌐 linkedin.com/company/  
nieman-raadgevende-  
ingenieurs-b-v-



Creating buildings for safe, healthy and comfortable use, that is what Nieman's consultants and engineers aim for. Together with our clients trying to improve the built environment towards a more sustainable and circular world.

Nieman is a multi-disciplinary engineering and consulting company providing state-of-the art advise in the building and construction branch. With over 150 employees Nieman is supporting its clients from initiative to building exploitation with building physics, fire safety engineering, acoustics as well as building services and MEP. Throughout all these disciplines we strive to add sustainable and energy-efficient solutions in our projects. Our expertise lies not only in designing new buildings. With a large track record of projects in renovating, retrofitting and transforming existing buildings Nieman is one of the leading companies in the field. Our clients cover the complete real estate and construction branch, including local and national governments.



Interested in working at Nieman? Scan the QR-code to view available vacancies.



## OLCO Maatschappelijk Vastgoed

### Branch

Management and Consultancy in public real estate

### HQ Location

Driebergen-Rijssenburg

### Employees

14



### Classification

- AUDE (A) ● SED
- AUDE (U) ● USRE
- BPS ● BT
- CME ● CT

### Contact person

Robert Klein

### Visiting address

Hoofdstraat 41B  
3971 KB  
Driebergen-Rijssenburg

+31 30 6930396

info@olco.nl

olco.nl

linkedin.com/company/olco



OLCO changes perspectives, as an advisor and as a developer. With this approach we pursue to translate a superficial tender to bigger ambitions. With over 60 years of experience, OLCO is a renowned 'green' advising consultancy in the fields of process management, exploitation consultancy and feasibility studies. Literally from the initiative to the realization, and beyond.

Our projects fall in public sectors as sports, offices and education and range from swimming pools and sports halls to schools, and townhouses. This sector is a stirring one with large, leading projects in which the shared vision forms the main driver, but where practical, political, financial and societal interests should always be balanced out.

A challenging field, but OLCO's twofold approach finds a way out: OLCO works both in the role of advisor next to the client as well as in the role of risk-taking developer for the client.

This yields a compelling expertise that enables our young and professional project leaders and managers to oversee the stakes and determine the actual interests in a tender.



### 'Groots Denken Concreet Maken'

In OLCO's perspective, sustainability goes beyond the development itself and therefore inspires us to look further. We do this in our 'Groen Doen' philosophy in which people, planet, profit and process form the pillars. This means we think further than wisely consuming energy and materials or financial benefits. We rather have a dialogue with the clients and users and excite them to realize successful, sustainable buildings. Successful for the user, the exploiter and the society. This implies we search for stake integration in favour of the users and a functional, optimally configured design that houses those. We take circular development as the norm and see Corporate Social Responsibility as a matter of course.

### Concretise your future

OLCO is always looking for ambitious young professionals that are ready to boost their professional career; as a junior project leader, as a graduate or as a (work)student. We take you along in our expertise in the diverse field and our vision in which sustainability and circularity are self-evident. And the users? They are without exception valued the key player in our approach towards a successful development. 'Groots Denken Concreet Maken' is our core business. And we dare you to do the same. Drop the standard thinking patterns and really fulfil your ambitions. See our job opportunities page where Jurriën and Carolien show you what working at OLCO looks like and how we concretise your future!

Interested in working at OLCO? Scan the QR-code to view available vacancies.







## Classification

- AUDE (A)    ● SED
- AUDE (U)    ● USRE
- BPS    ● BT
- CME    ● CT

**Contact person**  
Stefanie Stoffele, Recruitment

**Visiting address**  
Lindenlaan 41  
6584 AC  
Molenhoek

+31 85 8228600

[recruitment@peutz.nl](mailto:recruitment@peutz.nl)

[peutz.nl](http://peutz.nl)

[linkedin.com/company/peutz](https://www.linkedin.com/company/peutz)



# PEUTZ

Welcome at Peutz, a group of independent consultants specialized in a wide range of fields related to the design and building of any type of architectural or industrial development. Specialties range from acoustics, building physics and physics of urban design, noise control, and environmental technology to fire safety, sustainability and the optimization of working conditions. The Peutz Group is based in the Netherlands, Belgium, Germany and France, and has about 260 employees.

The solid reputation of Peutz is based on the quality of its consultancy work, with the use of advanced measuring and computing techniques and the availability of its own laboratories. Peutz' main clients are found in various industries, government agencies, and institutions in the cultural, health care and the education sectors.

The group was founded in 1954 and consists of seven firms with a total of 310 employees and 11 locations. Locations in the Netherlands are Haren (near Groningen), Eindhoven, Molenhoek (near Nijmegen) and Zoetermeer.

## Laboratories

Peutz Molenhoek operates laboratories for acoustics, building physics, wind technology and fire safety.



These laboratories are used for specific project-related research as well as fundamental research studies. Moreover, the laboratories are accredited for various standardized measurements. Customized solutions are created by linking laboratory research, field measurements, numerical simulations and expert knowledge. From the simple but efficient to the distinctive, daring and innovative.

## Social media

On our YouTube channel and social channels you can find several videos of tests in our laboratories and other interesting projects:

- [www.youtube.com/peutzbv](https://www.youtube.com/peutzbv)
- [www.instagram.com/peutzbv](https://www.instagram.com/peutzbv)
- [www.facebook.com/peutzbv](https://www.facebook.com/peutzbv)

## Ambition to work at Peutz?

A complex issue? You don't back down from that. In fact, you are looking for that challenge. You are a researcher, a puzzler, an inventor. Just like our people at Peutz. We work on the best technical solutions internationally. We are looking for someone who creates brilliant connections within existing frameworks. But don't worry, you don't have to do that on your own. At Peutz you surround yourself with sparring partners. Will you increase our impact?

Scan the QR-code or visit [www.werkenbijpeutz.nl](http://www.werkenbijpeutz.nl) to view available vacancies, internships and graduation opportunities at Peutz.



# Powerhouse Company International

Branch  
Architecture

HQ Location  
Rotterdam

Employees  
70

## Classification

- AUDE (A)
- AUDE (U)
- BPS
- CME
- SED
- USRE
- BT
- CT

Contact person  
Serena Zhang, HR

Visiting address  
Antoine Platekade 1000  
3072 ME  
Rotterdam

+31 10 4046789

hr@powerhouse-company.com

powerhouse-company.com

linkedin.com/company/  
powerhouse-company



# POWERHOUSE COMPANY

We are Powerhouse Company. We give meaning to space through profound form and function.

We are Powerhouse Company, an award-winning architecture office based in Rotterdam, the Netherlands. Our story begins in 2005. Newly founded back then, we operated from kitchen tables in Rotterdam and Copenhagen.

We have since grown into a multidisciplinary office of around 100 professionals, with international studios in Beijing, Oslo and Munich. Along the way we have won a number of prizes, including the Dutch Design Award, the Maaskant Prize and the World Architecture Festival Award.

Some things don't change however. We are still led by founder Nanne de Ru, these days along with Paul Stavert, Stijn Kemper, Stefan Prins, Sander Apperlo (Munich) and Johanne Borthne (Oslo).

Our mission is to create meaningful spaces that enhance people's lives. We shape our projects through the collective intelligence of our dedicated team, plus our in-depth research into the historical and future context. We love to be close to our clients, thinking along with them so that we can embrace their social, economic and sustainability goals.



Our multi-disciplinary team and collaborative ethos allow us to take full responsibility for any project, from sketch to construction.

We pride ourselves on the sensorial richness of our work, which results from our constant search for the sweet spot between constraints and possibilities. This process enables us to make conscious design decisions that enhance the subconscious design experience.

Our approach to function is based on our belief that every inch in and around a building should enrich the



overall sensation it creates. This is how we intertwine context, aesthetics and function. The outcome is the serene clarity that people sense in all our projects.

Interested in working at Powerhouse Company? Scan the QR-code to view available vacancies.





## RoosRos Architecten

### Branch

Architecture

### HQ Location

Oud-Beijerland

### Employees

70



### Classification

- AUDE (A)    ● SED
- AUDE (U)    ● USRE
- BPS        ● BT
- CME        ● CT

### Contact person

Henk de Gelder

### Visiting address

Laurens Janszoon Costerstraat 2  
3261 LH  
Oud-Beijerland

+31 18 6691580

info@roosros.nl

roosros.nl

linkedin.com/company/  
roosrosarchitecten



RoosRos Architects is a nationally-operating, full-service architecture agency with over sixty employees. We make architecture. And have been for over sixty years.

Whether the project is small or large, simple or complex, we ensure it's technically sound down to the smallest detail. Created within your budget and exceeding your expectations. We manage every project from concept development to technical execution and construction supervision. Regardless of whether it's a private commission or a large-scale multifunctional development. Our team consists of a mix of young enthusiastic talents and solid experienced practical experts. From our offices in Oud-Beijerland and Goes, we strive to realise meaningful architecture.

RoosRos stands for Respectful Stewardship. We feel a sense of responsibility for creating living, residential and work environments that contribute to people's happiness and well-being. Not only today but tomorrow as well, for current and future generations alike. There's a reason we centre our efforts on the mission of 'respectful stewardship'. We feel a duty to make every effort to both preserve our world and to leave it in the best possible shape once we are gone. Our mission has given rise to a vision: that of creating healthy and future-oriented designs.



Interested in working at RoosRos? Scan the QR-code to view available vacancies.



# Royal HaskoningDHV Nederland

## Branch

Engineering, other technical design  
and Consultancy

## HQ Location

Amersfoort

## Employees

6000



## Classification

- |            |        |
|------------|--------|
| ● AUDE (A) | ● SED  |
| ● AUDE (U) | ● USRE |
| ● BPS      | ● BT   |
| ● CME      | ● CT   |

## Contact person

Peggy van de Pas

## Visiting address

Larixplein 1  
5616 VB  
Eindhoven

+31 88 3484205

peggy.van.de.pas@rhdhv.com

royalhaskoningdhv.com

linkedin.com/company/  
royal-haskoningdhv



Royal HaskoningDHV is an independent, international engineering and project management consultancy with over 140 years of experience. Our professionals deliver services in the fields of aviation, buildings, energy, industry, infrastructure, maritime, mining, transport, urban and rural development and water.

Backed by expertise and experience of 6000 colleagues across the world, we work for public and private clients in over 140 countries. We understand the local context and deliver appropriate local solutions.

We focus on delivering added value for our clients while at the same time addressing the challenges that societies are facing. These include the growing world population and the consequences for towns and cities; the demand for clean drinking water, water security and water safety; pressures on traffic and transport; resource availability and demand for energy and waste issues facing industry. We aim to minimise our impact on the environment by leading by example in our projects, our own business operations and by the role we see in “giving back” to society.



By showing leadership in sustainable development and innovation, together with our clients, we are working to become part of the solution to a more sustainable society now and into the future.

Our head office is in the Netherlands, other principal offices are in the United Kingdom, South Africa and Indonesia. We also have established offices in Thailand, India and the Americas; and we have a long standing presence in Africa and the Middle East.

Interested in working at  
Royal HaskoningDHV?  
Scan the QR-code to view  
available vacancies.





## Scheldebouw

### Branch

Curtain wall industry

### HQ Location

Middelburg

### Employees

350



### Classification

- AUDE (A) ● SED
- AUDE (U) ● USRE
- BPS ● BT
- CME ● CT

### Contact person

Tim Debets, Sales & tender

### Visiting address

Smedestraat 2  
6411 CR  
Heerlen

+31 455 437411

t.debets@permasteelisagroup.com

scheldebouw.permasteelisagroup.com

linkedin.com/company/scheldebouw



Meet Scheldebouw, the partner for skyline changing buildings all over the world, a company which translates the ideas of the world's greatest architects into reality.

Originally founded in 1933 as a manufacturer of aluminium parts for the shipping and aviation sector, Scheldebouw quickly became a premium brand in façade construction when changing operations to the curtain wall industries in 1958. Becoming part of the Permasteelisa Group in 1995 led to a unique record of international landmarks like The Shard (London), MOL Campus (Budapest) and Varso Tower (Warsaw). Our work also shaped big cities in The Netherlands, for example with De Rotterdam, Stads Kantoor Utrecht and the new headquarters of Booking.com at Oosterdokseiland, Amsterdam.

Permasteelisa Group is a leading global contractor in the design, engineering, project management, manufacture, installation and after-sales service of architectural envelopes - beginning from the design development phases, working closely with architects like Herzog de Meuron, Foster+Partners and Renzo Piano, all the way to the successful completion. Successfully achieving the customer's highest expectations by exploiting our knowledge and experience and applying our engineering capabilities,



advanced technologies and eco-sustainable solutions to create a state-of-the art façade design. Our bespoke unitized façade is designed by our engineers and is subjected to an advanced structural, thermal and acoustic analysis, before the unitized façade panels are tested in our own testing facility. Finally, our commitment to sustainability, contributes to protecting the environment, makes the buildings themselves more livable and, in the end, improves the quality of the world we live in.

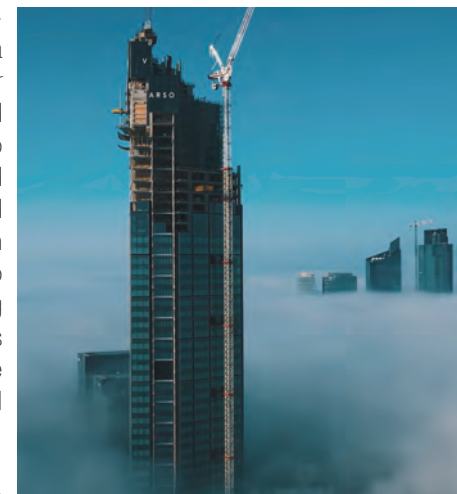

Present on four continents, with a network of around 40 companies in 30 countries and 9 production plants, the group generates a total turnover of around 1.1 billion euro a year. Of this global network 2 offices and 1 production plant are located in the Netherlands. Scheldebouw has around 350 employees, of which approximately 100 engineers, divided over the branches in Middelburg and Heerlen.

Scheldebouw is always looking for young talent, so if you are interested and want to know more about us, visit our Instagram and LinkedIn page for the latest news, or our website for more information.

Interested in working at Scheldebouw? Scan the QR-code to view available vacancies.



# Snijders Ingenieursgroep

**Branch**  
Construction

**HQ Location**  
Veldhoven

**Employees**  
80



## Classification

- |            |        |
|------------|--------|
| ● AUDE (A) | ● SED  |
| ● AUDE (U) | ● USRE |
| ● BPS      | ● BT   |
| ● CME      | ● CT   |

## Contact person

Sebastiaan van Ruitenbeek

## Visiting address

Nijverheidslaan 155  
5506 EC  
Veldhoven

+31 40 2085250

sr@snijders-ig.nl

snijders-ig.nl

linkedin.com/company/snijders-ig



Snijders Ingenieursgroep is an independent engineering office located in Veldhoven (near Eindhoven) and Valencia (Spain). We are concerned with giving advice in the field of building constructions.

With a team of experienced, driven and specialist engineers and 3D modelers we are capable of giving constructive advice for engineering projects in a skilled manner. As a team, we tackle all kinds of engineering challenges, mainly in the field of precast concrete constructions. Hereby, we deliver total engineering, from begin to end, in which our goal is to find the optimal solution for all parties.

Let's meet each other at our stand and our case!



Interested in working at  
Snijders Ingenieursgroep?  
Scan the QR-code to view  
available vacancies.





# Stadlander

## Branch

Public housing

## HQ Location

Bergen op Zoom

## Employees

180

## Classification

- AUDE (A) ● SED
- AUDE (U) ● USRE
- BPS ● BT
- CME ● CT

## Contact person

Liliana de Kok

## Visiting address

Rooseveltplaan 150  
4624 DE  
Bergen op Zoom

+31 6 53424229

P&O@stadlander.nl

stadlander.nl

linkedin.com/company/stadlander



# Stadlander

We are Stadlander. A social housing corporation in West-Brabant and Tholen (Zeeland), with 15,000 units. Our mission is to provide affordable housing for those with limited means. We are a frontrunner in the efforts to enable CO2 neutral housing by 2050. We have a drive for innovation and passion for sustainability. Continuously looking for suitable building and construction solutions in both densely populated and rural areas.

"We want our tenants to live in a pleasant sustainable environment, now and in the future. That is why we are investing heavily in our real estate, to ensure it is future proof", says Stefan van Loon, director Real Estate. "What sets us apart from others in our industry is that we look beyond the bricks, we truly want to make a societal impact. We want our tenant to call their house a home, this asks for a pleasant living environment that makes for a sense of belonging and the feeling of safety".

## Contributing to sustainable living and a better society.

Our Real Estate team consists out of two mayor units: property management and transformation. Both working closely together to reach an advantageous well maintained real estate portfolio. Working within a housing corporation allows you to experience the breadth of our field of work. To realize our goal of 200 newly build houses, we are always look for new and ingenious concepts. To ensure our portfolio is energy neutral in 2050, we also renovate about 200 units per year. On average, we annually invest 50 to 75 million euros.



New technologies are adapted quickly and we love the challenge of combining the old with the new.

Being a social housing corporation means that our employees have an intrinsic drive to contribute to society. We invest in the living environment itself, for instance by enabling social gatherings or supporting the neighborhood in sustainable initiatives. Our neighborhood teams are visible and approachable. Their input and that of our tenants helps us to set the right priorities on social and real estate developments within a neighborhood. We truly can make a positive impact.

## How Stadlander can help in your career aspirations.

At Stadlander we feel at home. Not only our tenants but also our employees. Working at Stadlander means working in a dynamic

environment. Our values are cooperation, pride, ambition, professionalism and commitment. We put our customers at the center of everything that we do.

At the same time we allow our employees to develop and progress their careers. We are ambitious and therefor invest in your potential. Stadlander has different functions that allow you to gain experience in project management, asset management or city development. And you might run into a familiar face with some of the TU Eindhoven Alumni working at Stadlander. Go to our website for more information or contact our HR department.

Interested in working at Stadlander? Scan the QR-code to view available vacancies.



# SVP architectuur en stedenbouw

## Branch

Architecture and Urban planning

## HQ Location

Amersfoort

## Employees

50



## Classification

- AUDE (A) ● SED
- AUDE (U) ● USRE
- BPS ● BT
- CME ● CT

## Contact person

Henriet Hoekstra

## Visiting address

't Zand 17  
3811 GB  
Amersfoort

+31 33 4701188

info@svp-svp.nl

svp-svp.nl

linkedin.com/company/  
svp-architectuur-en-stedenbouw



We are an office for architecture and urban design, based in the centre of the Netherlands. Some of our top projects are the International School in Utrecht, modular and temporary building SET in Amsterdam, researches like City of the Future and Onder de Zeeuwse zon, which looks for possibility of the combination of mussel production and solar energy on water. We look for circular, sustainable solutions on both architectural and urban design scale.

SVP is characterised by an open-minded approach in everything that we do. This is independent of whether it concerns a large or small scale project, something which we have done many times before or that is completely new to us. We integrate all our newly acquired knowledge, three decennia of experience, and personal strength and knowledge. It is a no-brainer that within our organisation there is a lot of cross-fertilisation between urban planning and architecture. It makes our plans better, more complete and more valuable. It leads to mutual respect, because only that way you can achieve the best results.

We have been around in the world of design for more than 35 years. The world, our world, has changed in these decennia. It became more complex, more parties are involved in projects,



the people have become more outspoken, local politics became truly local and the attention for sustainability, circularity and the environment nowadays occupy an essential and obvious central place, of course also in our thinking.

We are a group of nearly forty architects, urban planners and structural engineers. Our monumental office building is located against the centre of Amersfoort, but we also have a dependance at Amsterdam.

Interested in working at SVP? Scan the QR-code to view available vacancies.





## Sweco Nederland

### Branch

Consultancy and Engineering

### HQ Location

De Bilt

### Employees

17500



### Classification

- AUDE (A)    ● SED
- AUDE (U)    ● USRE
- BPS            ● BT
- CME           ● CT

### Contact person

Lindsay van Heugten, Recruitment

### Visiting address

De Holle Bilt 22  
3732 HM  
De Bilt

+31 6 23915317

lindsay.vanheugten@sweco.nl

sweco.nl

linkedin.com/company/sweco



Sweco plans and designs the communities and cities of the future. We do this by offering qualified services in the fields of consulting engineering, environmental technology and architecture.

Do you want to make a difference? Then Sweco is the place to be. Together with our customers we plan and design the communities and cities of the future. We give you the opportunity to work on the most challenging international, national and regional projects. Enabling you to develop professionally and collaborate closely with our customers is the key to Sweco's continued success.

To us, continuous improvement is not optional – it's a requirement. It is also what makes Sweco such a rewarding place to work, regardless of whether you're a recent graduate or an experienced consultant. Sweco is a company for employees who want to perform and create value for their customers and where we all make important contributions to the customer experience.

Working at Sweco, you will be part of a dynamic team where everyone counts and where everyone is approachable and committed with a recognized expertise. In such an environment, it is a pleasure to work at Sweco and with Sweco.



Interested in working at Sweco? Scan the QR-code to view available vacancies.



## Tentech

### Branch

Engineering and other technical design and Consultancy

### HQ Location

Utrecht

### Employees

14



### Classification

- AUDE (A) ● SED
- AUDE (U) ● USRE
- BPS ● BT
- CME ● CT

### Contact person

Wilbert Eskes

### Visiting address

Rotsoord 9A  
3523 CL  
Utrecht

+31 6 13066652

✉ wilbert@tentech.nl

🌐 tentech.nl

🌐 linkedin.com/company/  
tentech-bv



Tentech is an innovative design- and engineering consultancy specialized in lightweight structures. Our architects and engineers focus on membrane structures, temporary structures, complex geometries and the use of distinctive materials. In addition to fabric, steel, wood and aluminium, Tentech explores the implementation of cardboard, (3d printable) synthetic material and bamboo.

### Lightweight construction

Tentech, as a design consultancy, has a unique role. We are often asked to participate in specific parts of a project, whenever a combination of modern craftsmanship and attention to detail is required. We do not necessarily reserve this expertise for lightweight structures. For example, we also use our knowledge and experience to work on industrial processes and product innovations.

### Modeling and analysis

Another important aspect of our service is controlling complex membrane-shapes. We possess the expertise and techniques to model and analyse tensile structures and to convert 3D complex surfaces into 2D cutting patterns. Additionally, we take care of the structural feasibility of products. We strive for a sustainable relationship with our clients. Hence, we are committed to point out innovation opportunities and possibilities for product improvements.



### Regulations for temporary structures

Tentech operates worldwide. Hence, we have extensive knowledge of (inter)national laws and regulations concerning permanent and temporary structures. Started as a spin-off from the Faculty of Civil Engineering at Delft University of Technology, Tentech was founded in 1997.

Our multidisciplinary team consists of architects, structural engineers, architectural technologists, industrial designers and CAD engineers.

Interested in working at Tentech? Scan the QR-code to view available vacancies.





## Turner & Townsend

**Branch**  
Consultancy

**HQ Location**  
Leeds

**Employees**  
6801



### Classification

- AUDE (A)    ● SED
- AUDE (U)    ● USRE
- BPS            ● BT
- CME           ● CT

### Contact person

Paloma Cilleruelo, Recruitment

### Visiting address

Rembrandt Tower – Level 2  
Amstelplein 1  
1096 HA Amsterdam

☎ +31 20 658 0060

✉ paloma.cilleruelo@turntown.com

🌐 turnerandtowntsend.com

🌐 linkedin.com/company/  
turner-&-towntsend



Turner & Townsend is one of the leading consultancies in the Netherlands, with a central hub in Amsterdam, more than 100 colleagues and revenue of €15M. Worldwide we operate across 111 offices with more than 6800 employees and revenue of € 800M.

Together we implement exciting and complex projects for (inter)national clients such as Schiphol, Shell, Microsoft and Nissan, to name but a few.

If you have the ambition to work for an internationally renowned consultancy, push boundaries and really make the difference, then we are looking for YOU! The opportunity to be involved in a diverse range of projects across the globe will be a big part of why you'll love to work with Turner & Townsend. You'll also enjoy to be a part of our young, diverse and international team and have fun with your colleagues during regular social events.

Importantly, you get the opportunity to fast track your career and join our Graduate Development Programme: During a two/three year period you will get the chance to work on different projects across our four sectors real estate, infrastructure, industrial and energy and you'll discover which profession you're drawn most to: project management or cost management.



Our programme provides you with a structured learning environment that supports you to become a well-rounded consultant. This will help you to plan your learning needs for you to progress in your career with us.

Are you ready to build your future? Meet us at our stand and start shaping your future today! We will help you realise your true potential with defined learning and development programmes and

opportunities to join company-wide communities to shape your professional profile. With the right attitude and drive, you will find your place in the exciting consultancy world of the construction industry.

Interested in working at Turner & Townsend? Scan the QR-code to view available vacancies.



# TwynstraGudde

## Branch

Organisation and Consultancy

## HQ Location

Amersfoort

## Employees

300



## Classification

- AUDE (A)    ● SED
- AUDE (U)    ● USRE
- BPS    ● BT
- CME    ● CT

## Contact person

Quincy Burke

## Visiting address

Oliemolenhof 14a  
3800 AX  
Amersfoort

+31 6 29042037

uqb@tg.nl

twynstragudde.nl

linkedin.com/company/  
twynstragudde



TwynstraGudde is an independent and leading Dutch strategic and organizational consultancy firm. We mainly work on strategic and social relevant issues that have impact on (semi-) government and business organizations. These issues are complex and unique projects that can only be solved by sustainable, creative and innovative solutions.

We work in the field of real estate, housing, spatial investments, area development, as well as security, care, energy, water, education, mobility and infrastructure. These subjects are classified in ten groups.

Our group is Housing, Real Estate & Facility Management. We work in the fields of real estate policy, portfolio management, portfolio sustainability, project management, housing and workplace concepts, feasibility studies and financial business cases.

We believe in the development of our advisors. Therefore, from the moment you start working, you will be given a lot of responsibility. Together with your project members you will be in contact with clients and be challenged to use your skills in practice. While working on multiple projects, you will get a lot of freedom and flexibility in organizing your work and your week.



To guide you on the job, you will get a mentor and enthusiastic colleagues. Together with your colleagues you can make a difference for our clients.

In addition to learning on the job, our junior advisors are offered an extensive educational program. In this program you will learn about aspects that will improve you as a young professional. Focus in this program is the development of skills and deploying these skills into practice.

Besides working, together with our team, we organize informative and social activities. In addition, we like to visit completed projects together

with our colleagues and we organize fun activities with other young TwynstraGudde colleagues.

Do you want to know more about what we do, what our working week looks like and who our clients are? Then contact us! We are always looking for enthusiastic and ambitious students and graduates who are looking for a (graduation) internship or a job.

Interested in working at TwynstraGudde? Scan the QR-code to view available vacancies.





## VeriCon Ingenieurs Veldhoven

### Branch

Built environment

### HQ Location

Veldhoven

### Employees

95



### Classification

- AUDE (A)
- AUDE (U)
- BPS
- CME
- SED
- USRE
- BT
- CT

### Contact person

Paula Jansen

### Visiting address

de Plank 100  
5504 ED  
Veldhoven

+31 85 0866800

werken@vericon.nl

vericon.nl

linkedin.com/company/  
vericoningenieurs



# VeriCon

With an enthusiastic team of almost 100 employees in our offices in Veldhoven and Druten, we are continuously working on improving our expertise and knowledge on structural design and engineering. Concrete, steel or wood; houses, high-rise buildings or specials, we never shy away from a challenge. Variation, that's exactly what we like!

We believe that innovation is essential for making buildings more efficient, better, cheaper and more manageable. Therefore, we exclusively model in 3D. We work with an advanced package of calculation software. Are there any improvements possible? Our team of developers will work on it.

VeriCon optimises the added value of structural designs in the building process. We do by means of automation in an innovative way in a complex construction world. Our structural designers put structural safety first. From 3D models and structural calculations to the control of machines in factories: everything in one system. Working with BIM guarantees easy sharing of information and prevents false interpretations.

By working with advanced calculation and modelling software, we are able to elaborate clear structural data much further than is traditionally customary. We are even able to establish links with ERP systems and production facilities at construction partners from our 3D models.

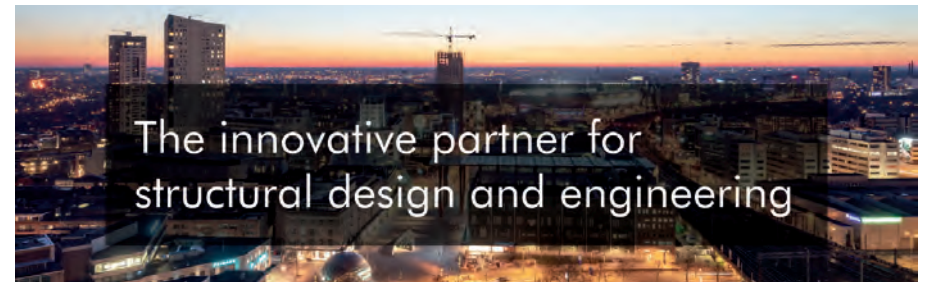

One of the applications we work with is Grasshopper, this is used for parametric design. Our parametric way of design results in quicker, more cost effective and optimal solutions for your projects. Parametric design lets you specify the key parameters of your project and make changes interactively, with the model updating automatically.

Through continuous development and innovation, we create solutions that enable partners to work carefree, more economically and more efficiently, while also inspiring our colleagues to continue to innovate and develop themselves.

Collaboration is a prerequisite for any construction contract; in our vision this is one of the keys to optimal results in terms of quality, budget and planning. The choice of project organisation, systems and working method makes it possible - together with other partners -

to arrive at a reliable structural design that integrates architecture, economic aspects, building technology and the environment.

At VeriCon we have a close relationship with the engineers of tomorrow. We have good contacts with various educational institutions - we give guest lectures, participate in career events and sponsor student associations. And we work a lot with students. Interns, graduation traineeships, working students and dual students. At VeriCon you will gain practical experience, whereby you will be guided by the best in the field. With us, you will learn the total package, from which you will benefit a lot in the future.

Interested in working at VeriCon? Scan the QR-code to view available vacancies.



# VolkerWessels Bouw & Vastgoedontwikkeling

## Branch

Construction and Real estate development

## HQ Location

Rijssen

## Employees

3800



## Classification

- AUDE (A) ● SED
- AUDE (U) ● USRE
- BPS ● BT
- CME ● CT

## Contact person

Dave Vervoord

## Visiting address

Laan van Vredenoord 14  
2289 DJ  
Rijswijk

+31 6 16514551

dvervoord@volkerwessels.com

volkerwessels.com

linkedin.com/company/volkerwessels



VolkerWessels is a leading international construction company that operates according to the 'think global, act local' principle. VolkerWessels is active in the Netherlands, the United Kingdom, North America and Germany and has over 130 local operating companies.

VolkerWessels plays a key role in society with projects and services that contribute sustainably to the living environment. We build on living, working and mobility.

Although the statutory board of VolkerWessels is head quartered in Rijssen, most of our colleagues are located in one of our main offices situated in Amsterdam, Rotterdam, and Rijswijk.

VolkerWessels is represented at the Bouwkunde Bedrijvendagen by its main construction companies Boele & van Eesteren and Visser & Smit Bouw.



Interested in working at VolkerWessels? Scan the QR-code to view available vacancies.





## Voort

### Branch

Secondment

### HQ Location

Utrecht

### Employees

84



### Classification

- AUDE (A) ● SED
- AUDE (U) ● USRE
- BPS ● BT
- CME ● CT

### Contact person

Michelle Peeters

### Visiting address

Schoutlaan 11  
6002 EA  
Weert

+31 6 82487419

m.peeters@voort.com

voort.com

linkedin.com/company/voort



# voort

We are a secondment company. We help you find a job that makes you happy and allows our clients to find the right people. Due to a lack of technical talent, time and resources, our clients often have difficulty finding the right people. As a seconded employee, you are employed by us but work for one of our clients. As your employer, we are responsible for all work-related matters, such as career counselling, development opportunities and salary.

Not to mention, when you complete a project, there'll be several opportunities for progress. Together we'll look at what suits your career best. All this allows our clients to apply your knowledge, while you're guaranteed a good contract and competitive salary at the same time.



# Groei verder. Ga Voort

Interested in working at Voort? Scan the QR-code to view available vacancies.



**Branch**  
Engineering

**HQ Location**  
Deventer

**Employees**  
1300



## Classification

- AUDE (A)    ● SED
- AUDE (U)    ● USRE
- BPS    ● BT
- CME    ● CT

**Contact person**  
Pepijn Gerritsen, HR

**Visiting address**  
Leeuwenbrug 8  
7400 AE  
Deventer

+31 6 86849753

[pepijn.gerritsen@witteveenbos.com](mailto:pepijn.gerritsen@witteveenbos.com)

[witteveenbos.com](http://witteveenbos.com)

[linkedin.com/company/witteveen-bos/](https://www.linkedin.com/company/witteveen-bos/)



# Witteveen + Bos

## Talented engineers and consultants with ambition

Witteveen+Bos offers its clients value-added consultancy and top-quality designs for water, infrastructure, environment and construction projects.

With a staff of more than 1.300 employees, we are part of the top ten Dutch engineering and consultancy firms. We use our high-end expertise to resolve complex issues and are a committed partner for our clients. Our vision is to offer the very highest level of quality. This means: aiming to be very good at what we do, collaborating with other top experts, and maintaining a culture of entrepreneurship and trust.

Visit our website [www.witteveenbos.com](http://www.witteveenbos.com) where you can find information about our vacancies, internships and thesis possibilities. We also organize several (online) business courses every year.



Interested in working at Witteveen+Bos? Scan the QR-code to view available vacancies.





## Zonneveld ingenieurs

Branch  
Engineering

HQ Location  
Rotterdam

Employees  
70

### Classification

- AUDE (A) ● SED
- AUDE (U) ● USRE
- BPS ● BT
- CME ● CT

### Contact person

ir. Koen van Uffelen, Structural engineer

### Visiting address

Delftseplein 27H  
3013 AA  
Rotterdam

+31 10 4528888

info@zonneveld.com

zonneveld.com

linkedin.com/company/  
zonneveld-ingenieurs-b.v.



We are Zonneveld ingenieurs. A structural engineering office with over 30 years of experience in amongst others high-rise buildings, utility buildings, residential buildings and infrastructure constructions.

Both new construction, transformation and monitoring projects are among our references. We also have 20 years of experience with seismic & safety engineering, which includes extensive expertise in resistance of buildings to earthquakes and the impact of possible terrorist acts. We use advanced software and methodologies that are partly developed in-house, including 3D modelling, 3D-FEM calculation software for support structures and simulations and visualizations using virtual twins.

We are a tight-knit team of venturous professionals, who gladly put money where our mouths are and who have the ambition to make the best of themselves and our projects. Many have been working together for many years. Others are young talents, whom we warmly welcome. Management consists of four passionate structural advisors.

Different in age, style and speciality, all share one similarity: they solve similar problems in a similar way. The result of a company culture which has been formed in decennia. It is a fact that it is a man's



world mainly, but not a choice! Which is to say: we are always open for change, but the good quality remains the same. New buildings form a large part of our projects. Large, complex innercity projects, such as Beursplein in Rotterdam, high-rise projects such as the Maastower in Rotterdam and the ministries of Safety&Justice and The Interior&Kingdom Affairs in The Hague and office buildings such as the new EPO head quarters along the A4 high way are part of our references.

Transformation and redevelopment is one of the work areas of Zonneveld ingenieurs. On our long list of transformation projects you will find the transformation of Cool63 in the centre of Rotterdam, the transformation of Sijthoff in the centre of The Hague, the Dordrechts museum in Dordrecht and the Wijnhavenarea in The Hague.

Safety is a hot issue in the public eye of late. Zonneveld ingenieurs already has some 20 years experience in engineering earthquake resisting buildings. The past few years we have been intimately involved in earthquake



engineering of hundreds of buildings in the Groningen area in The Netherlands.

Currently, Zonneveld together with Fugro is also involved in a pilot with tilt sensors, which have been placed on several locations throughout the Groningen earthquake area. See also the website of the National Coordinator Groningen NCG.

Interested in working at Zonneveld ingenieurs? Scan the QR-code to view available vacancies.



# VISIT MYFUTURE.TUE.NL

To find all career activities held at the TU/e

MyFuture.tue.nl

My Future is the collective existing of career organizations spread among the TU/e campus



MY FUTURE

CAREER

YOU

TU/e

CAREER  
ACADEMY

TU/e

SKILLS  
LAB

## WHAT DO YOU NEED TO KNOW?

### TU/e CAREER ACADEMY

We offer to help all students prepare for their career:

- Personal CV, cover letter and LinkedIn advice via email
- One-on-one career coaching with a career advisor
- LinkedIn photoshoot sessions at events
- An active community of alumni, recruiters and students on LinkedIn
- Career Development workshops (e.g. Cover Letter & CV, Job Interview, contract negotiations, self-assessment)

Need our help? Contact us!

✉ careeracademy@tue.nl    @ tue\_career\_academy  
🌐 tuecareeracademy.nl    f TUECareerAcademy  
📌 TU/e Career Academy Network

### TU/e SKILLSLAB

We offer a broad range of workshops, To develop your professional skills. Topics include:

- Presenting and pitching
- Academic writing (e.g. Thesis)
- Teamwork
- Time and stress management
- Personal development
- Much more, make a request if you want

Lets stay in touch!

✉ skillslab@tue.nl    @ tueskillslab  
🌐 skillslab.tue.nl    f tueskillslab



# Expressions of Gratitude

*Board 2020-2021*

We would like to take the opportunity to thank all participants who made this 21st edition of the Bouwkunde Bedrijvendagen possible. As a board, we put our best effort into improving the Bouwkunde Bedrijvendagen and organizing events which contribute to the networking skills and professional network of both students and companies. We hope everyone had educative, insightful and enlightening weeks of events.

As of March 14th 2022, this edition of the Bouwkunde Bedrijvendagen will come to an end.

Since appointed in April we, as the 20th board, were able to continue with a strong base laid by our previous board. We want to thank them all for their previous contributions and a special thanks goes out to the 19th board, who guided us as our advisory board. Furthermore, all three committees within the board showed enthusiasm, willingness to learn and improve and dedication. The Business Contact committee managed to create and maintain an extensive network of participating companies. The Organization Day committee created the fundamentals for all the events and showed flexibility within COVID-19 scenarios. The Promotion committee managed to reach students from all over via multiple channels of promotion. Additionally, we would like to thank our main sponsor Turner & Townsend for their confidence, help and contributions.

In organizing and promoting our events, the study associations played a meaningful role. We want to thank them for their cooperation and contributions to this years event.

To all the participating students, companies, sponsors, volunteers, the Committee of Recommendation and the 19th board of the Bouwkunde Bedrijvendagen, thank you for your interest, dedication and hard work for this year! We hope to see you all during the next edition!

- The 20th board of the Bouwkunde Bedrijvendagen

Thank you for participating!  
See you at the next edition in November 2022



**BOUWKUNDE  
BEDRIJVEN  
DAGEN**